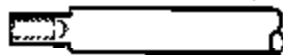

ILLUSTRATION SHOWS TYPICAL PARTS ONLY. ORDER BY PART NUMBER. PARTS NOT LISTED ARE SUPPLIED BY OEM.

47



47A



47B

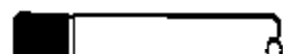

48



48A

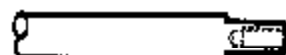

48B

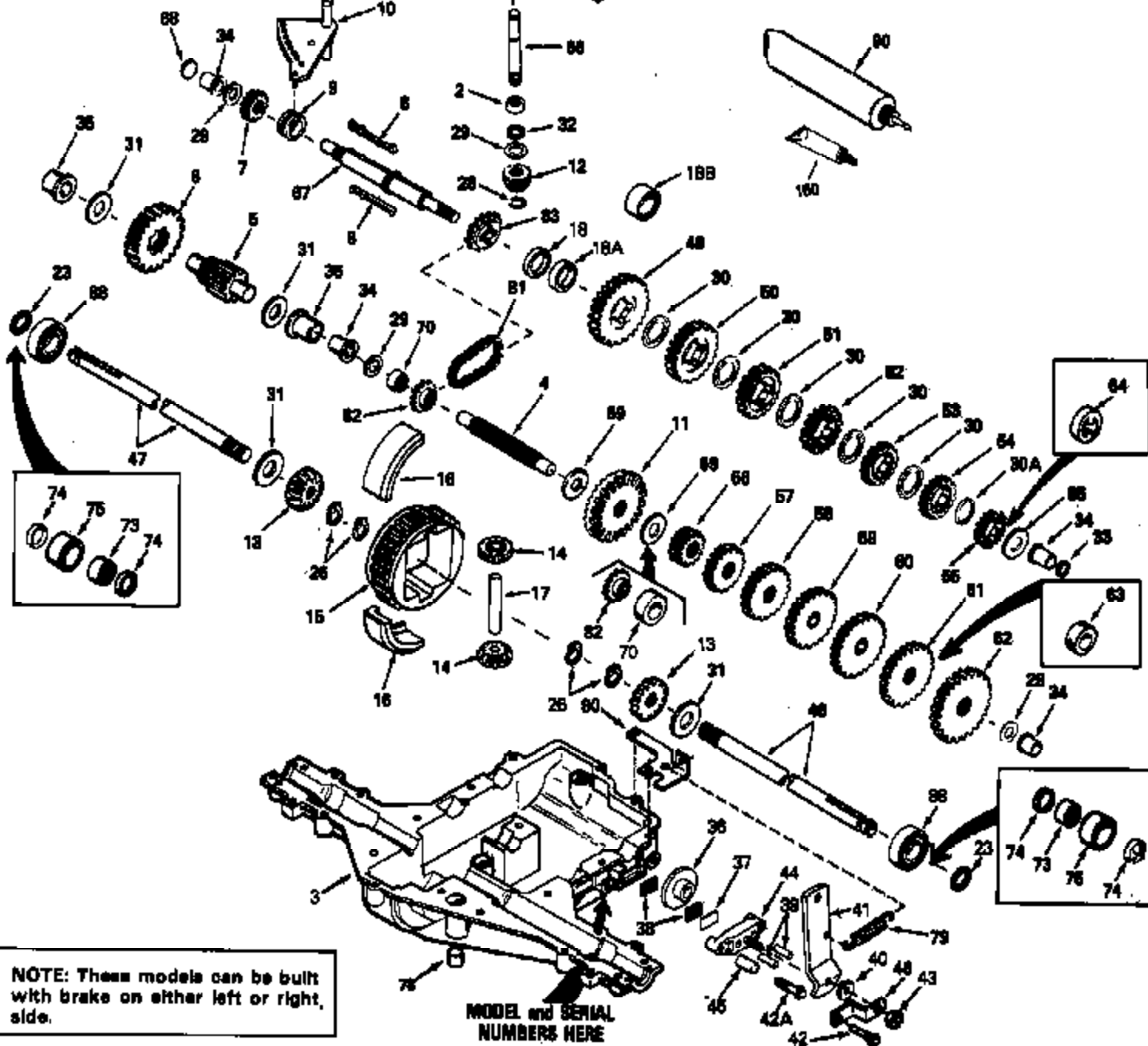
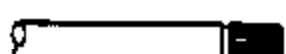

NOTE: These models can be built with brake on either left or right side.

MODEL and SERIAL NUMBERS HERE

| Ref # | Part Number | Qty          | Description  |
|-------|-------------|--------------|--|
| 1     | 772094      |              | Transaxle Cover  |
| 2     | 780086A     |              | Needle Bearing   |
| 3     | 770082      |              | Transaxle Case   |
| 4     | 776260A     |              | Countershaft   |
| 5     | 776219A     |              | Output Shaft & Pinion  |
| 6     | 778139      |              | Output Gear  |
| 7     | 778136      |              | Spur Gear (15 teeth-steel)   |
| 8     | 792123A     |              | Key  |
| 9     | 784216      |              | Shifter Collar   |
| 10    | 784337A     |              | Shift Rod & Fork   |
| 11    | 778229      |              | Bevel Gear (42 teeth-steel)  |
| 12    | 778113A     |              | Input Bevel Pinion   |
| 13    | 778221      | 920-920-005A | Bevel Gear   |
| 14    | 778068      | Peerless     | Bevel Pinion Gear  |
| 15    | 778165      |              | Ring Gear  |
| 16    | 786101      |              | Bearing Block  |
| 17    | 786040      |              | Drive Pin  |
| 18B   | 786102      |              | Neutral Spacer (.700/.690 thick) NOTE: Instead of one (1) No.786102 spacer, some early production models may have been built with two (2) No.786121 spacers. |
| 20    | 792077A     |              | Steel Ball, 5/16" dia.   |
| 21    | 792078      |              | Set Screw, 3/8-16 x 3/8"   |
| 22    | 792079      |              | Spring   |
| 23    | 788061      |              | Seal Ring  |
| 25    | 792073A     |              | Screw, 1/4-20 x 1-1/4"   |
| 26    | 792125      |              | Retainer Ring  |
| 27    | 792035      |              | Retainer Ring  |
| 28    | 788040      |              | Retainer Ring  |
| 29    | 780072      |              | Thrust Washer  |
| 30    | 780108      |              | Thrust Washer  |
| 31    | 780001      |              | Washer   |
| 32    | 792001      |              | "O" Ring   |
| 33    | 788051A     |              | Square Cut Seal  |
| 34    | 780105A     |              | Flanged Bushing  |
| 35    | 780118A     |              | Flanged Bushing  |
| 36    | 790003      |              | Brake Disk   |
| 37    | 790007      |              | Brake Pad Plate  |
| 38    | 799021      |              | Brake Pad (Pkg. of 2)  |
| 39    | 786026      |              | Dowel Pin  |
| 40    | 792076A     |              | Flat Washer  |
| 41    | 790019      |              | Brake Lever  |
| 42    | 792073A     |              | Screw, 1/4-20 x 1-1/4"   |
| 42A   | 792085A     |              | Screw, 1/4-20 x 2-1/4"   |
| 43    | 792075      |              | Lock Nut, 5/16-24  |
| 44    | 790025      |              | Brake Pad Holder   |
| 45    | 786066      |              | Spacer (1/2" OD x 17/64" ID x 1" long )  |
| 46    | 786086      |              | Brake Lever Bracket  |
| 47    | 774690      |              | Axle (11-15/16" long)  |
| 48    | 774691      |              | Axle (16-1/2" long)  |
| 49    | 778215      |              | Spur Gear (37 teeth)   |
| 50    | 778125      |              | Spur Gear (35 teeth)   |
| 51    | 778124A     |              | Spur Gear (30 teeth)   |
| 52    | 778123A     |              | Spur Gear (25 teeth)   |
| 53    | 778122A     |              | Spur Gear (22 teeth)   |
| 54    | 778273      |              | Spur Gear (19 teeth-steel)   |

| Ref # | Part Number | Qty          | Description                             |
|-------|-------------|--------------|---|
| 56    | 778230      |              | Spur Gear (12 teeth-steel)              |
| 57    | 778151      |              | Spur Gear (15 teeth)                    |
| 58    | 778126A     |              | Spur Gear (20 teeth)                    |
| 59    | 778127A     |              | Spur Gear (25 teeth)                    |
| 60    | 778128A     |              | Spur Gear (28 teeth)                    |
| 61    | 778163      |              | Spur Gear (31 teeth)                    |
| 65    | 780109      |              | Thrust Washer                           |
| 66    | 776135      |              | Input Shaft (3.687" long)               |
| 67    | 776273      |              | Brake Shaft (4-keyed)                   |
| 68    | 786116      |              | Disk                                    |
| 69    | 780051      |              | Thrust Washer                           |
| 70    | 786118      |              | Spacer (1" OD x .765 ID x .717 thick)   |
| 71    | 788069      | 920-920-005A | Square Cut Seal                         |
| 72    | 792074      | Peerless     | Threaded Plug, 9/16-18                  |
| 81    | 786081      |              | Roller Chain (No. 41 chain, 24 links)   |
| 82    | 786082      |              | Sprocket (9 teeth)                      |
| 83    | 786123      |              | Sprocket (18 teeth)                     |
| 90    | 788067B     |              | Grease (32 oz. bottle Bentonite grease) |
| 150   | 510334      |              | Gasket Eliminator (Loctite No. 515)     |

920-920-005A Page 3 of 8