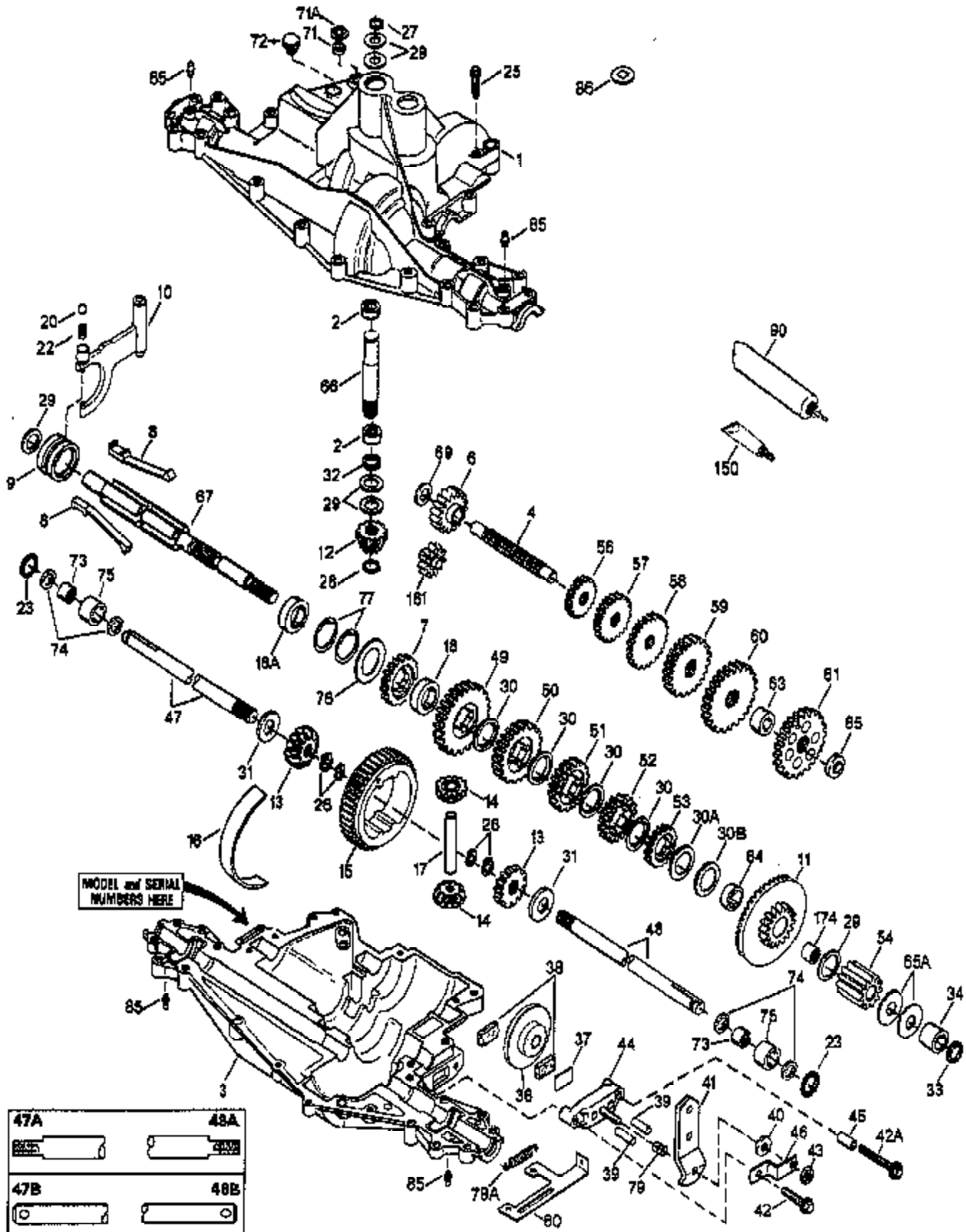

ILLUSTRATION SHOWS TYPICAL PARTS ONLY. ORDER BY PART NUMBER. PARTS NOT LISTED ARE SUPPLIED BY OEM.



| Ref # | Part Number | Qty | Description |
|-------|-------------|--------------|----------------------------|
| 1 | 772117 | | Transaxle Cover |
| 2 | 780086A | | Needle Bearing |
| 3 | 770110 | | Transaxle Case |
| 4 | 776300 | | Countershaft (4.877" long) |
| 6 | 778281 | | Spur Gear (16 teeth) |
| 7 | 778122A | | Spur Gear (22 teeth) |
| 8 | 792160 | | Shifter Key |
| 9 | 784352 | | Shifter Collar |
| 10 | 784365 | | Shift Rod & Fork |
| 11A | 778290 | | Bevel Gear (44 & 16 teeth) |
| 12 | 778262 | | Input Bevel Pinion |
| 13 | 778221 | | Bevel Gear |
| 14 | 778068 | 915-915-011B | Bevel Pinion Gear |
| 15 | 778260 | Peerless | Ring Gear |
| 16 | 786150 | | Bearing Strip |
| 17 | 786139 | | Drive Pin |
| 18 | 786147 | | Neutral Spacer |
| 20 | 792139 | | Steel Ball, 3/8" dia. |
| 22 | 792142 | | Spring |
| 23 | 788061 | | Seal Ring |
| 25 | 792073A | | Screw, 1/4-20 x 1-1/4" |
| 26 | 792125 | | Retaining Ring (pkg of 2) |
| 27 | 792035 | | Retaining Ring |
| 28 | 788040 | | Retaining Ring |
| 29 | 780072 | | Thrust Washer |
| 30 | 780108 | | Thrust Washer |
| 30A | 780145 | | Thrust Washer |
| 30B | 780178 | | Thrust Washer |
| 31 | 780001 | | Washer |
| 32 | 792001 | | "O" Ring |
| 33 | 788076 | | Square Cut Seal |
| 34 | 780159 | | Bushing |
| 36 | 790071 | | Brake Disk |
| 37 | 790007 | | Brake Pad Plate |
| 38 | 799021 | | Brake Pad (pkg of 2) |
| 39 | 786026 | | Dowel Pin |
| 40 | 792076A | | Flat Washer |
| 41 | 790045 | | Brake Lever |
| 42 | 792073A | | Screw, 1/4-20 x 1-1/4" |
| 43 | 792075 | | Lock Nut, 5/16-24 |
| 44 | 790025 | | Brake Pad Holder |
| 46 | 786086 | | Brake Lever Bracket |
| 47B | 774922 | | Axle (16-3/16" long) |
| 48B | 774923 | | Axle (11" long) |
| 49 | 778125 | | Spur Gear (35 teeth) |
| 50 | 778250 | | Spur Gear (27 teeth) |
| 51 | 778122A | | Spur Gear (22 teeth) |
| 52 | 778273 | | Spur Gear (19 teeth) |
| 54 | 778263 | | Spur Gear (11 teeth) |
| 56 | 778151 | | Spur Gear (15 teeth) |
| 57 | 778249 | | Spur Gear (23 teeth) |
| 58 | 778128A | | Spur Gear (28 teeth) |
| 59 | 778129A | | Spur Gear (30 teeth) |
| 61 | 778265 | | Spur Gear (34 teeth) |
| 65 | 780162 | | Thrust Washer |
| 65A | 780160 | | Thrust Washer |

| Ref # | Part Number | Qty | Description |
|-------|-------------|--------------|---|
| 66 | 776299 | | Input Shaft (3.522" long) |
| 67 | 776352 | | Brake Shaft (4-keyed) |
| 69 | 780161 | | Thrust Washer |
| 71 | 788069 | | Square Cut Seal |
| 72 | 792074 | | Threaded Plug |
| 76 | 780090 | | Thrust Washer |
| 77 | 788078A | | Inverted Retaining Ring (pkg of 2) |
| 79 | 792144 | | Brake Spring |
| 90 | 788067B | | Grease (32 oz. bottle Bentonite greas e) |
| 150 | 510334 | | Gasket Eliminator (Loctite #515) |
| 161 | 776302 | | Reverse Idler Ass'y |
| 174 | 780085 | | Needle Bearing |
| 799D | 799008 | 915-915-0115 | Shifting Gear Set (steel) (Incl. 49 & 56) |
| 799C | 799005 | Peerless | Ring Gear & Spur Gear Set (Incl. 15 & 54) |
| 799B | 799004 | | Differential Gear Set (steel)(Incl. 1 3 & 14) |
| 799A | 799002 | | Shifter Key Set (Incl. 4 of 8) |
| 799 | XXXXX | | OPTIONAL KITS AVAILABLE |
| 799H | 799020 | | Brake Disk Set (Incl. 36, 37 & 2 of 3 8) |
| 799G | 799019 | | Detent Spring & Ball Set (Incl. 20 & 22) |
| 799F | 799010 | | Shifting Gear Set (steel) (Incl. 51 & 58) |
| 799E | 799009 | | Shifting Gear Set (Incl. 50 & 57) |

915-915-0115 Page 3 of 3
Peerless