

**PART NO. 17304 REV. 1**

Printed in U.S.A.

Price 35¢

# *Parts List*

# **DM 50**

## **HOMELITE® Multi-Purpose Saw**

**UT05020**

**UT05021**

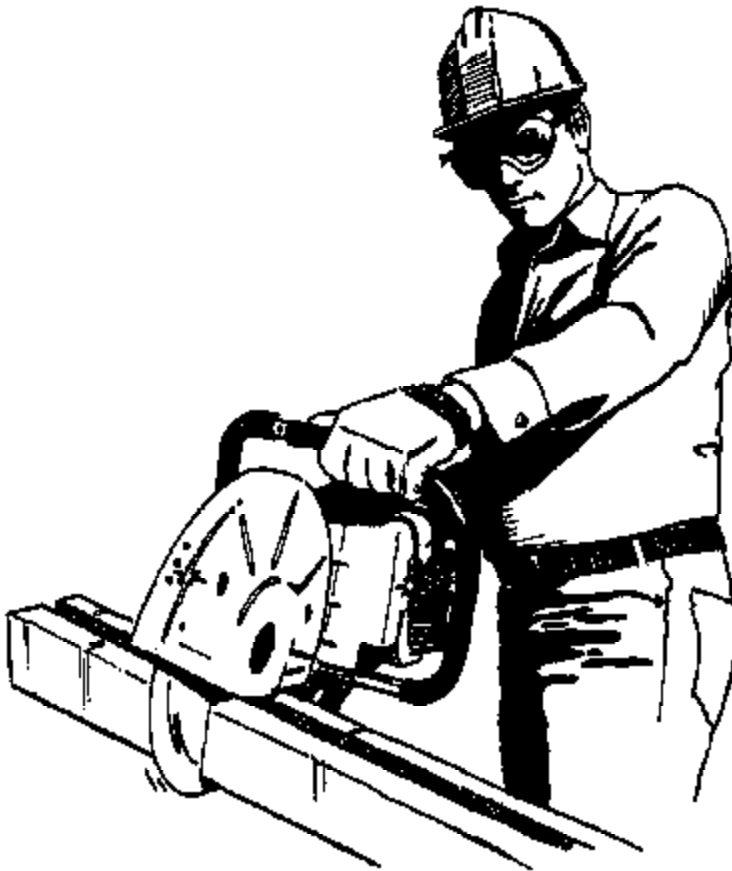

**HOMELITE TEXTRON**

Homelite Division of Textron Inc.



**FIGURE 2**

**DM 50**  
Multi-Purpose Saw

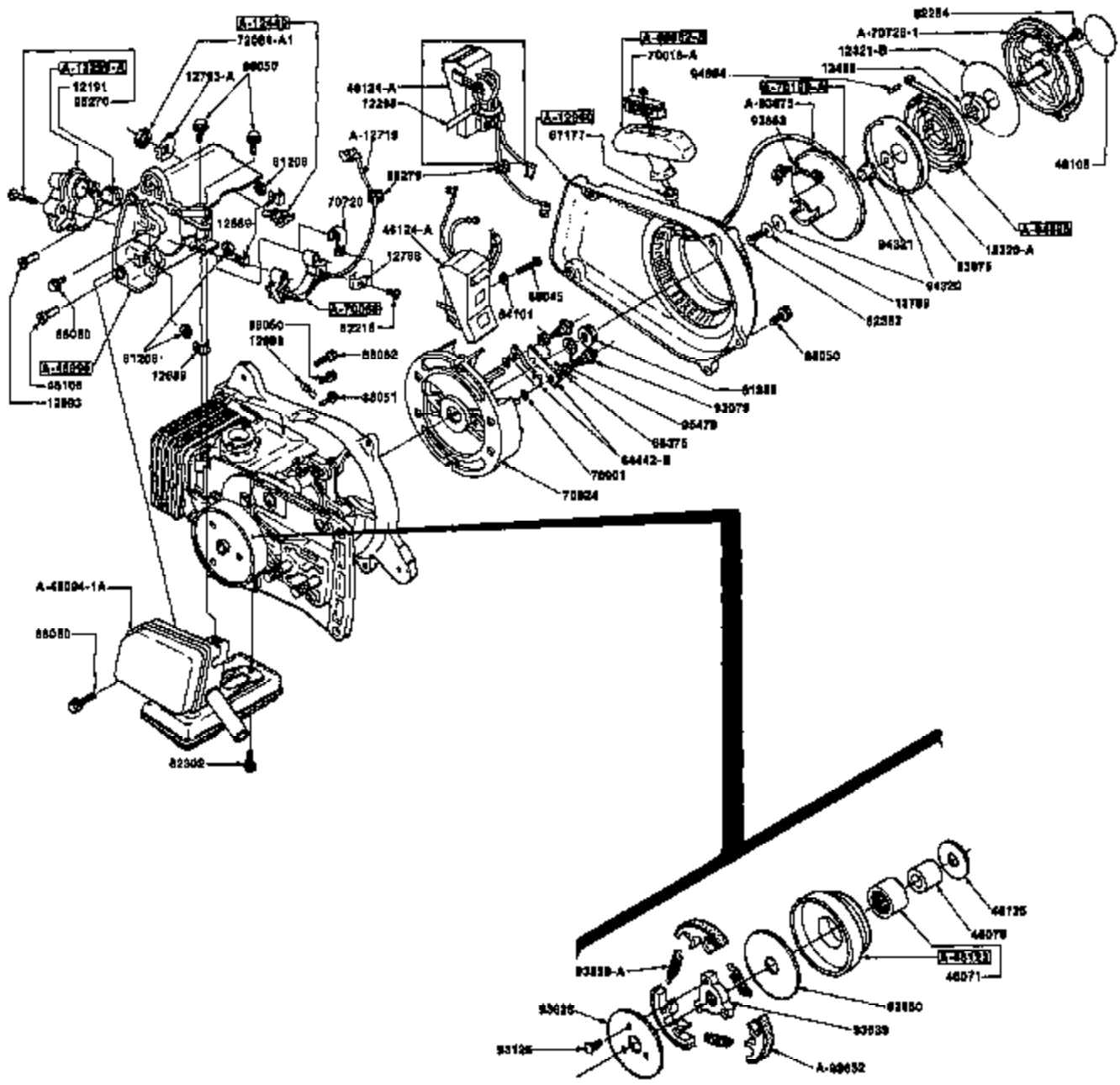

ALWAYS FURNISH MODEL AND SERIAL NUMBER WHEN ORDERING PARTS. 3  
 NUMBERS IN BOXES ARE ASSEMBLIES. ASSEMBLY BREAKDOWNS ARE LISTED NUMERICALLY IN THE BACK OF THE BOOK.

**DM 50**  
Multi-Purpose Saw

**FIGURE 3**

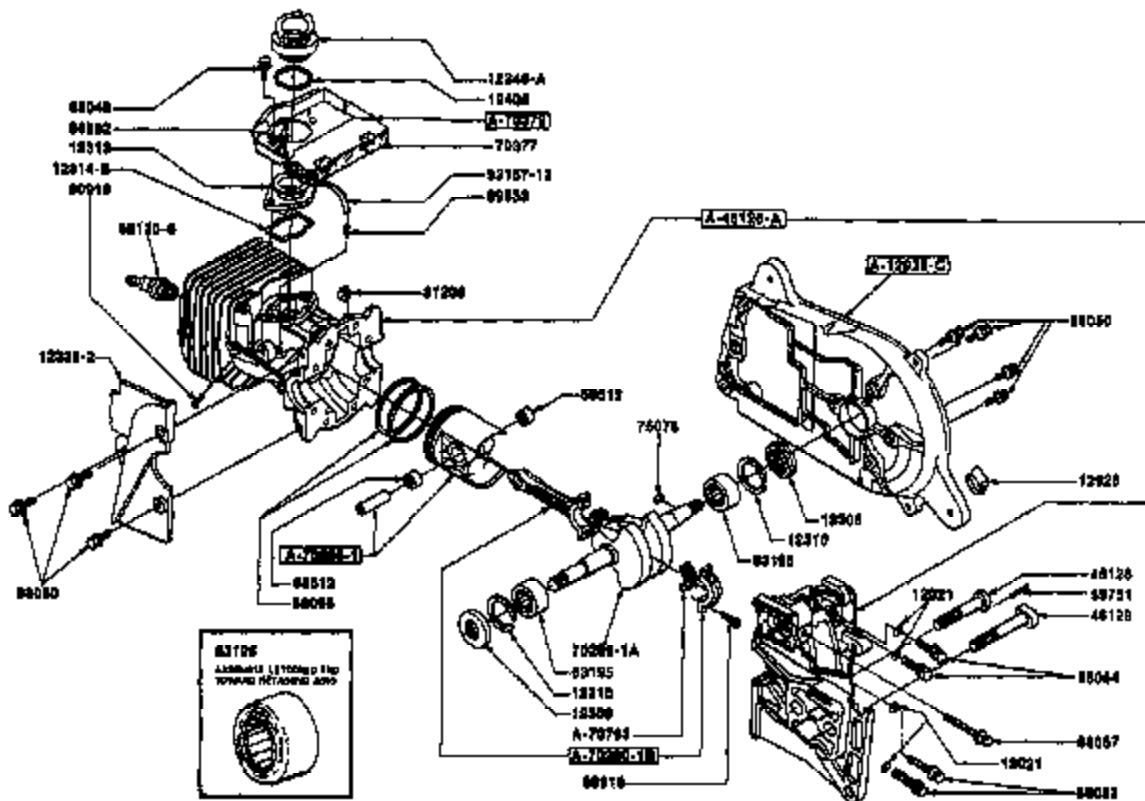



**DM 50**  
Multi-Purpose Saw

**FIGURE 5**

**CARBURETOR**  
**A-46938**  
**SDC-71**

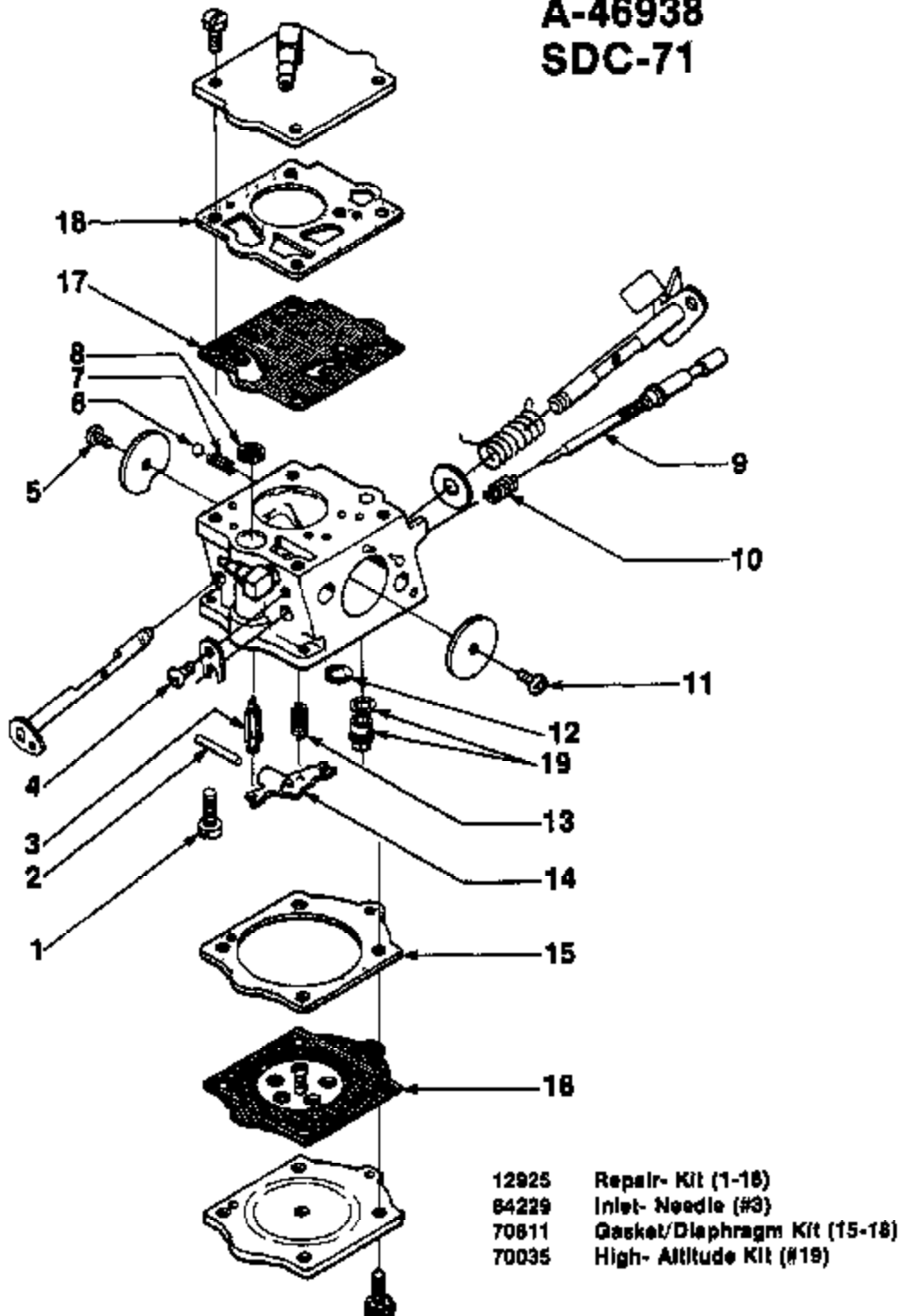

# DM 50 Multi-Purpose Saw

## ACCESSORIES

CLUTCH TOOL	A-17148
WRENCH HEX SOCKET	22128
KEY- Hex	23528
ADHESIVE	70627
DC 4 COMPOUND	22638-B
SLEEVE- Seal protecting	23759
BRACKET- Rotor remover	A-24290
SHIM- Plastic	24853
TOOL & PLUNGER- Piston pin	A-24871
CD TEST LAMP	A-24894
WET CUTTING KIT	A-66477
WHEEL- Reinoid concrete (std)	64993-B9
WHEEL- Reinoid concrete (DM 50-1 only)	47448
WHEEL- Reinoid Metal (opt)	64597-B9
WHEEL- Reinoid Metal (DM 50-1 only)	47450
WHEEL- Reinoid Durolife (opt)	66421-A9
BLADE- Carbide	64696-B
WRENCH- Combination	A-24086-A
SCREWDRIVER	24541
WRENCH- Socket	68861
KIT- Emergency	A-47305
KIT- Muffler spark arrester	A-47323
ROPE- Starter (250' reel, #5)	61084-1
KIT- Pulse line	A-89072
Tubing- Rubber (10 ft)	63112-98

PART NO.	DESCRIPTION	QTY.
12021	WASHER- Conical	4
12098	BUMPER (1)	2
12191	GROMMET	1
12298	CABLE- Tie	1
A-12299-A	TRANSFORMER & GROMMET	1
	Includes	
12191	GROMMET	1
65270	SCREW- Mach hex hd (1)	2
12308	SEAL- Mann	2
12310	RING- Retaining	2
12313	DUCT- Intake	1
12314-B	GASKET- Intake duct	1
12320-A	SHIELD- Spring (outer)	1
12321-B	SHIELD- Spring (inner)	1
12336-2	SHIELD- Sprocket	1
12340	SPACER	1
12348-2A	BRACE- Rear handle	1
12348-A	CONNECTOR- Carb	1
12349	ROD- Choke	1
12350	ROD- Throttle	1
12351	COVER- Throttle handle	1
12352	TRIGGER	1
12406	SPRING- Garter	1
12410	GROMMET	1
12423	PIN- Choke lever	1
12440	SCREW- Bat	1
12441	SPRING- Torison	1
A-12448	SWITCH	1
	Includes	
72084-A1	NUT- Hex	2
12454	SPRING	1
12458	LOCK- Spring	1
12481	PIN- Groove	1
12484-1	LOCK- Trigger	1
12620	LEVER- Choke	1
12688	NUT- Retainer	3
A-12719	MODULE- Lead	1
12783	SCREW- Idle adjusting	1
12784	SPRING- Idle adjusting	1
12788	CONTACT- Transformer	2
12789	WASHER- Retaining	1
72783-A	PLATE- Indicating	1
A-12803-A	SNUBBER- Rear	1
12890	NUY	2
12896	CLAMP- Wire	1
12898	KIT- Repair	1
12928	SNUBBER	1
A-12938-C	BACK PLATE & SNUBBER	1
	Includes	
12928	SNUBBER- Back plate	1
A-12960	HOUSING- Starter	1
	Includes	
67177	BUSHING- Starter cover	1
12999	BUSHING	1
*A-17148	TOOL- Clutch	1

PART NO.	DESCRIPTION	QTY.
*22128	WRENCH- Socket hd	1
*22638-B	COMPOUND- DC 4	1
*23528	WRENCH- Hex	1
*23759	SLEEVE- Crankcase seal	1
*A-24086-A	WRENCH- Adjusting	1
*A-24290	BRACKET- Rotor removal	1
*24541	SCREWDRIVER	1
*24853	SHIM- Plastic	1
*A-24871	TOOL- Plunger	1
*A-24894	LAMP- CD test	1
31748	RING- Retaining	1
A-43482-1A	GUARD- Wheel	1
43473-1	COVER- Air filter	1
43658	COVER- Arm	1
43896-1	FLANGE- Wheel (DM 50 only)	2
43897-1	FLANGE- Wheel (DM 50-1 only)	2
43998-1A	PULLEY- Drive	1
46000	WASHER- Mounting	1
46001	SUPPORT- Air filter	1
46065	WASHER- Retaining	1
46066	WASHER- Flat	1
46087	SPACER- Bearing	1
46088	BELT- V-drive	1
46070	RACE- Inner	1
46071	BEARING- Needle	1
46072	RING- Retaining	2
46073	ELEMENT- Air filter	1
46078	KNOB	2
46077	SCREW- Same hex hd 3/8-24 x 3/4	1
46078-A	SHAFT- Wheel (DM 50-1 only)	1
46079-A	SHAFT- Wheel (DM 50 only)	1
46081	SCREW- Cap hex hd 10-24 x 3/8	2
46083-1	SUPPORT- Foot	1
A-46084-1A	MUFFLER	1
A-46099	BRACKET- Mounting	1
A-46103	HANDLE BAR & BRACE	1
	Includes	
82245	SCREW- Cap hex hd 10-24 x 1	1
49106	BUSHING- Nylon	1
48108	DECAL	1
46110	GASKET	1
A-46112-3	TANK- Fuel	1
A-46113-1	COVER- Drivecase	1
A-46123	PULLEY- Bearing and drum	1
	Includes	
46071	BEARING- Needle	1
46124-A	MODULE & CORE	1
A-46126-A	CRANKCASE & CYLINDER	1
	Includes	
12313	DUCT- Intake	1
12314-B	GASKET- Intake duct	1
12348-A	CONNECTOR- Carb	1
12406	SPRING- Garter	1
46128	BOLT- Arm	1
46129	BOLT- Arm	1
46130	SCREW- Mach hex hd 5/16-18 x 2	1
46136	WASHER- Thrust	1
46455	TUBING- Rubber	1
46458-A	SPACER- Guard adjusting	1
46462	"O" RING	3
*A-66477	KIT- Wet cutting	1
46786	COVER- Felt element	1
46787	WASHER	1
A-46938	CARBURETOR- (SCD-71)	1
46943-01	STRIP- Protective 2 T2	1
46943-02	STRIP- Protective 3 T2	1
A-46995	SHIELD- Cylinder	1
	Includes	
12993	BUSHING	1
46108	BUSHING- Nylon	1
47207	RING- Retaining	1

## DM 50 Multi-Purpose Saw

PART NO.	DESCRIPTION	QTY.	PART NO.	DESCRIPTION	QTY.
*A-47306	KIT- Emergency	1	A-70286	SHIELD- Muffler	1
*A-47393	KIT- Muffler spark arrestor	1		Includes	
47387	SHIM	1	70377	SEAL	1
47388	SPRING- Wave	1	70378	CUSHION	1
A-47407	ARM- Wheel	1	70299-1A	CRANKSHAFT	1
	Includes		A-70300-1B	ROD- Connecting	1
47387	SHIM	1		Includes	
47388	SPRING- Wave	1	99919	SCREW- Cap hex soo hd	2
*47449	WHEEL- Resinoid (DM 50-1 only) Con	1		8-32 x 1/2	
*47450	WHEEL- Resinoid (DM 50-1 only) Met	1	70377	SEAL	2
*57084-1	ROPE- Starting (250' reel. #5)	1	70378	CUSHION	1
A-59251	PICK UP- Fuel	1	A-70379	DEFLECTOR- Air	1
	Includes			Includes	
59253-1	ELEMENT- Fuel filter	1	70377	SEAL	1
59751	PIN- Dowel	1	A-70421-A	ISOLATOR- Vibration	5
83107-8	BEARING- Ball	3	*70527	ADHESIVE	1
83196	BEARING- Roller	2	70720	CONTACT- Ground	1
83975	RING- Retaining	1	A-70725-1	COVER- Starter housing	1
84229	NEEDLE- Intnl	1	A-70793	NEEDLE- Bearing	2
*84442-B	PAWL- Starter	2	70811	KIT- Gasket/diaphragm	1
*84595-B	BLADE- Carbide	1	70901	WASHER- Lock #12	2
*84598-BB	WHEEL- Resinoid (DM 50 only) Con	1	70924	ROTOR	1
*84597-BB	WHEEL- Resinoid (Metal)	1	72064-A1	NUT- Hex	1
84582	GROMMET	1	75078	KEY- Woodruff	1
85130-B	SPARK PLUG	1	80919	SCREW- Pan hd. 4-40 x 1/4	4
85375	SPRING- Starter pawl	2	81198	NUT- Hex 5/16-18	1
87177	BUSHING- Starter cover	1	81208	NUT- Locking hex (10-24)	12
88086	RING- Piston	2	81246	NUT- Hex locking (1/2-13)	1
88279	GROMMET	1	81285	NUT- Locking hex (Rotor) (3/8-24)	1
*88421-A3	WHEEL- Resinoid (Ductile)	1	82215	SCREW- Plastic (# 8 x 3/8)	2
88512	BEARING	2	82246	SCREW- Cap soo hd (10-24 x 1)	4
88548	PIN- Trigger	1	82254	SCREW- Mach. Pan hd (8-32 x 1/2)	3
*88881	WRENCH- Socket	1	82256	SCREW- Pan hd 5 x 250	1
89461	VALVE- Check	1	82302	SCREW- Cap socket hd (1/4-20 x 5/8)	2
89464	FILTER- Fuel cap	1	82371	BOLT- Step (5/16-18 x 2 1/2)	1
A-89500-A	CAP- Fuel filter	1	82393	SCREW- Truss hd (10-24 x 1/2)	1
	Includes		83110	WASHER- Lock helicoil	8
89451	VALVE- Check	1	84026	WASHER- Flat (1/4)	3
89454	FILTER- Fuel cap	1	84101	WASHER- Flat #8	1
89601	GASKET	1	85041	SCREW- Hex Semi 8-32 x 3/8	4
89502	CHAIN- Bead	1	88045	SCREW- Hex Semi 8-32 x 1 25	1
89503	RETAINER	1	88049	SCREW- Hex Semi 10-24 x 500	4
82259	SCREW- 5 x 250	1	88050	SCREW- Hex Semi 10-24 x 825	23
89501	GASKET	1	88051	SCREW- Semi hex hd	
89502	CHAIN- Bead	1		(#10-24 x 3/4)	4
89503	RETAINER	1	89062	SCREW- Semi hex hd	
89833	FITTING- Tube	1		10-24 x 875	2
89919	SCREW- Cap	2	88063	SCREW- Hex Semi 10-24 x 1 00	2
A-89982-B	GRIP- Starter	1	88064	SCREW- Cap socket hd	
	Includes			10-24 x 1 250	5
70015-A	INBERT- Rope retaining	1	88056	SCREW- Hex Semi 10-24 x 1 375	2
70019-A	COVER- Handle	1	88087	SCREW- Hex Semi (#10-24 x 2)	1
70036	KIT- High altitude	1	*A-93072	KIT- Pulse line	1
A-70053-C	HANDLE- Throttle	1	93079	STUD- Shoulder	2
A-70055-1	PISTON & PIN	1	93112-42	TUBING- Rubber 10 1/2"	1
	Includes		*93112-88	TUBING- Rubber (10 ft)	1
88088	RING- Piston	2	93125	SCREW- Torx	3
88512	BEARING	2	93157-12	TUBING- Rubber 3 1/4"	1
A-70066	RECEPTACLE- Transformer	1	93628	COVER- Clutch	1
	Includes		A-93632	SHOE- Clutch	3
95270	SCREW- Mach hex hd	2	93634-A	SPRING- Clutch	3
A-70199-A	PULLEY- Starter	1	93639	SPIDER- Clutch	1
	Includes		93660	WASHER- Thrust	1
93882	WASHER- Nylon	1	93682	WASHER- Nylon	1
94320	WASHER	2	A-93675	ROPE- Starter	1
94321	BUSHING- Starter	1	94143	SCREW- Slotted hex hd	
				1/4-20 x 1 1/4	3
			94320	WASHER	2
			94321	BUSHING- Starter post	1
			94684	SLEEVE- Pin	1
			A-94685	SPRING- Rewind	1
				Includes	
			94854	SLEEVE- Pin	1
			95270	SCREW- Machine hex hd	2
			95478	WASHER- Flat	1

## HOMELITE CONSTRUCTION & INDUSTRIAL EQUIPMENT

14401 Carowinds Blvd. • P.O. Box 7047 • Charlotte, North Carolina 28217

**HOMELITE TEXTRON**

Homelite Division of Textron Inc