

PARTS LIST

for **JACOBSEN** **CHIEF LAWN AND GARDEN TRACTOR**

8 H.P. TRACTOR, NO. 53033
SERIAL NO. 1601 AND UP
POWER DRIVE CLUTCH, NO. 59755

10 H.P. TRACTOR, NO. 53037
SERIAL NO. 1601 AND UP
POWER DRIVE CLUTCH, NO. 59756

12 H.P. TRACTOR, NO. 53038
SERIAL NO. 1601 AND UP
POWER DRIVE CLUTCH, NO. 59756

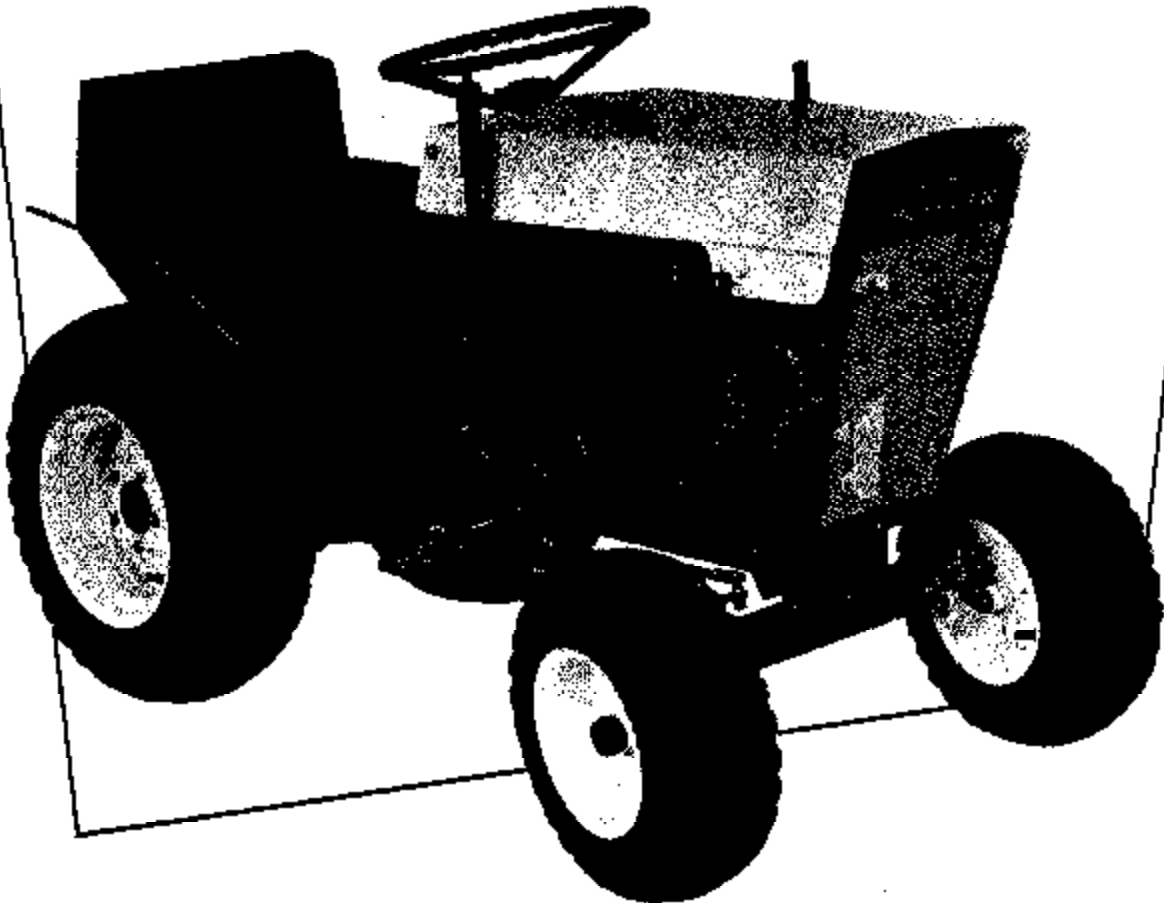

JACOBSEN MANUFACTURING COMPANY
RACINE, WISCONSIN 53403

Part No. 343273

ILLUSTRATION 1.

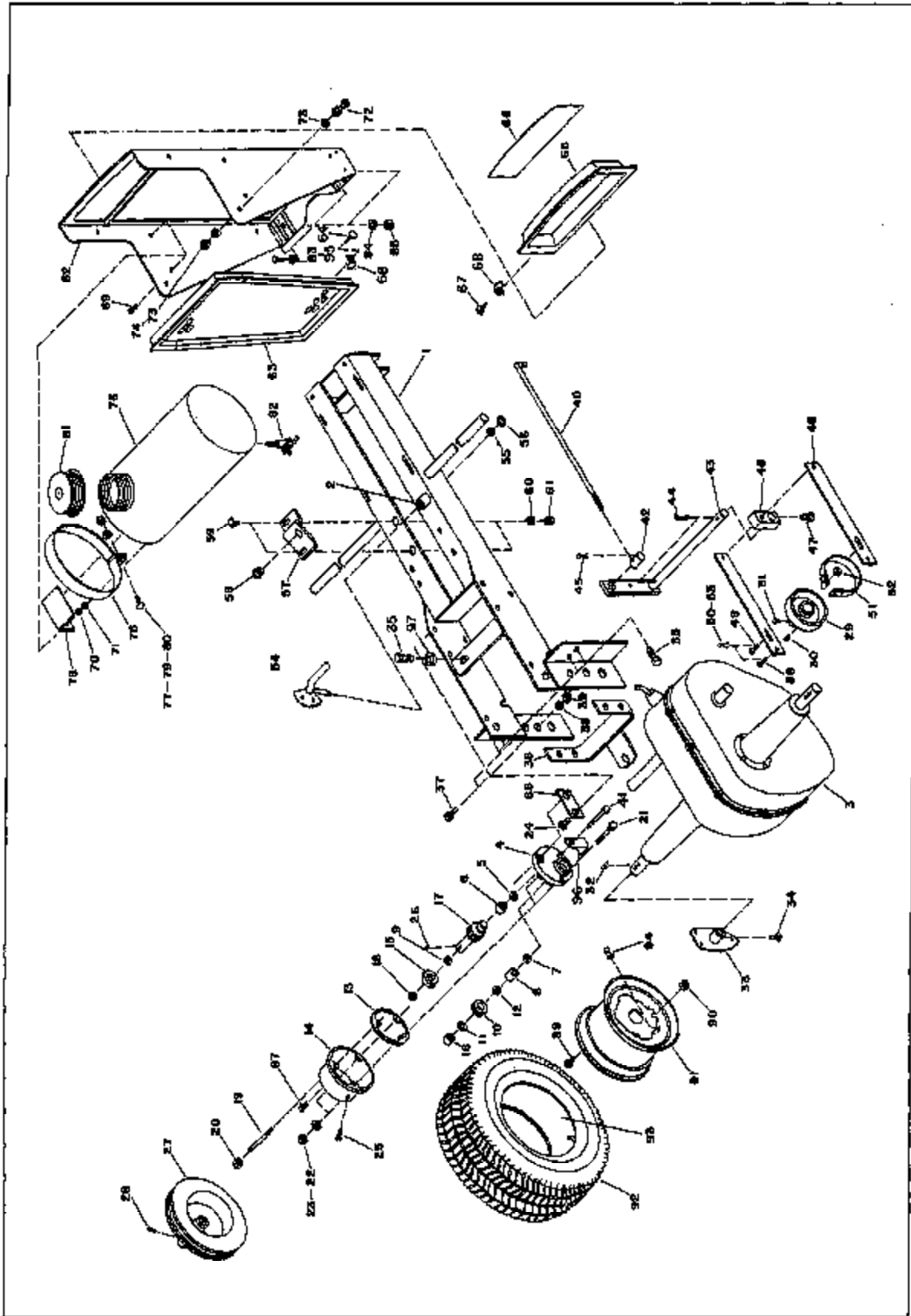

PARTS LIST 8 H.P. TRACTOR ILLUSTRATION 1.

Ref. No.	Part No.	Quantity	Description	Ref. No.	Part No.	Quantity	Description	Ref. No.	Part No.	Quantity	Description
1	114026	1	Frame Assembly	36	153562	1	Hitch Assembly	69	400186	2	Screw - 5/16-18 x 1/8 Hex Hd. Cap - Fuel Tank
2	345388	2	Bushing - Steering Quad. Pivot	37	400264	4	Screw - 3/8-16 x 1-1/4 Hex Hd. Cap Hitch Mfg.	70	446134	2	Lockwasher - 5/16 Med. - Fuel Tank Brkt. Mfg.
3	11402A	1	Transmission Assembly (See Breakdown on Page 5)	38	446140	4	Lockwasher - 3/8 Med. - Hitch Mfg.	71	443106	2	Nut - 5/16-18 Hex - Fuel Tank Brkt. Mfg.
4	239017	1	Housing - Input Gear	39	443110	4	Nut - 3/8-16 Hex - Hitch Mfg.	72	343700	2	Washer - 1/2 SAE - Hood Fastener Mfg.
5	342529	1	Washer - Thrust	40	342641	1	Rod - Brake Actuator	73	3065043	4	Fastener Mfg.
6	342560	1	Needle Bearing	41	400200	1	Screw - 6/16-18 x 2-1/2 - Hex. Hd. Cap	74	443518	2	Nut - 1/2-18 - Hex Jam Hood Fastener Mfg.
7	331572	1	Oil Seal - Input Shaft	42	342840	1	Retainer - Brake Rod	75	306601	2	Strap - Fuel Tank Mfg.
8	308554	1	Needle Bearing	43	153563	1	Brake Shaft and Arm Assembly	76	107250	1	Fuel Tank
9	342776	1	Washer - Thrust	44	460082	2	Pin - 1/8 x 1-1/2 Cotter - to Brake Arm Mfg.	77	402232	2	Screw - 1/4-20 x 1-1/4 Rd. Hd. Mach. - Fuel Tank Strap Mfg.
10	500383	1	Gear - Reverse w/Shaft - Input (Illus. 2 - Ref. 39)	45	460316	1	Rear Pin Cotter - Rod Retainer to Brake Arm Mfg.	78	325602	2	Bracket - Fuel Tank Mfg.
11	458432	1	Snap - Ring	46	342642	1	Arm - Brake Band Tightener	79	446128	2	Lockwasher - 1/4 Med. - Fuel Tank Strap Mfg.
12	342776	1	Washer - Thrust	47	412035	1	Screw - 3/8-16 x 3/4 Sq. Hd. Cup Pt. Set - Brake Band Tightener to Shaft Mfg.	80	443102	2	Nut - 1/4-20 Hex - Fuel Tank Strap Mfg.
13	342558	1	Gasket - Bouncing Inner	48	342649	2	Arm - Brake Slide	81	153492	1	Fuel Tank Cap Assembly
14	218012	1	Housing - Outer Input Gear	49	461487	1	Pin - 3/8 Clevis - Brake Slide Arm Mfg.	82	106597	1	Shut - off Valve Assembly
15	342563	1	Ball Bearing - Input Gear	50	460014	1	Pin - 5/32 x 3/4 Cotter - Clevis Pin Retaining	83	400264	2	Screw - 3/8-15 x 1-1/4 Hex Hd. Cap - Front Cowling to Frame Mfg.
16	342561	1	Needle Bearing - Input Shaft	51	163636	1	Brake Band and Lining Assem.	84	446140	2	Lockwasher - 3/8 Med. - Front Cowling to Frame Mfg.
17	331626	1	Gear - Input	52	463011	1	Washer - 3/8 SAE	85	443110	2	Nut - 3/8-16 Hex - Front Cowling to Frame Mfg.
18	331672	1	Oil Seal - Input Gear Shaft	53	460014	1	Pin - 3/32 x 3/4 Cotter - Brake Band Mfg.	86	343766	1	Spring - Gear Box Mfg.
19	342850	1	Band - Reversing Gear Box to Frame Mfg.	54	126200	1	Steering Quadrant Assembly	87	343766	1	Plug - 1/4-18 Hex Slot - Mag - Metric Oil Level Plug
20	342784	1	Nut - 5/16-18 Hex SAE STD. High - Reversing Gear Box to Frame Mfg.	55	326063	1	Washer - Quadrant Retainer	88	461468	1	Pin - 3/8 Clevis - Brake Band Mfg.
21	400196	2	Cap Screw - 5/16-18 x 2-1/4 Hex Hd. - Inset to Outer Bag.	56	459407	1	Ring - National #XCS - 126 Retaining Quadrant Retaining	89	315298	10	Bolt - Rear Wheel Mounting
22	446134	2	Lockwasher - 5/16 Med.	57	107962	1	Steering Support Brkt. and Bush Assembly	90	443116	4	Nut - 7/16-20 Hex - Extra Wheel Bolt Mounting
23	443106	3	Nut - 5/16-18 Hex - Gear Box Assem. & Spring to Frame Mfg.	58	315315	1	Bushing - Steering Rod	91	107940	2	Rear Wheel Disc Assembly
24	400184	1	Screw - 5/16-18 x 3/4 Hex Hd. Cap - Spring to Frame Mfg.	59	400226	2	Screw - 5/16-24 x 1 Hex Hd. Cap Steering Support Brkt. Mfg.	92	331241	2	Wheel - Rear Wide Base (Standard)
25	412001	1	Pipe Plug - 1/8 Screw Driver Slot Rd. - Oil Level and Filler	60	446134	2	Lockwasher - 5/16 Med. - Steering Support Brkt. Mfg.	93	315298	2	Rear Wheel Tire 6.00 x 12 (Standard)
26	462017	1	Woodruff Key - Pulley Mfg.	61	443103	2	Nut - 5/16-24 Hex - Steering Support Brkt. Mfg.	94	341880	2	Tire Valve - Rear Wide Base Tire
27	318013	1	Pulley - Tran. Input	62	205219	1	Cowling Front	95	303873	2	Washer - Front Cowling to Frame Mfg.
28	412027	1	Set Screw - 3/8-15 x 5/8 Sq. Rd. Cap Pt. - Pulley to Shaft	63	331595	1	Grille - Front Cowling	96	342859	1	Bracket - Belt Retainer
29	239023	1	Drum - Brake	64	409028	4	Screw - #10 x 5/8 Rd. Hd - Pad. Hd. - Machine Grille Mfg.	97	303873	1	Washer - Trans. to Frame Mfg.
30	463017	1	Key - Woodruff 40 - 3/16 x 3/4 - Drum Mfg.	65	331536	1	Plate - Name				
31	412012	1	Screw - 5/16-18 x 1/2 Sq. Hd. Cup Pt. Set - Drum Mfg.	66	331570	1	Decal - Tractor Name				
32	463038	2	Key 1/4 x 1-1/8 Woodruff #18 Wheel Hubs to Rear Axles	67	409029	2	Screw - #10 x 5/8 Rd. Hd. - Phil. Hd. - Name Plate Mfg.				
33	202323	2	Hub - B.H. and L.H. Rear Wheel	68	445253	6	Speed Nut - Tinn. - Name & Plate Mfg. & Grille Mfg.				
34	412059	2	Screw - 3/8-16 x 1 Sq. Hd. Kn. Cap Pt. Set - Wheel Hubs to Rear Axles								
35	400262	5	Screw - 3/8-16 x 1 Hex Hd. Cap Transmission to Frame								

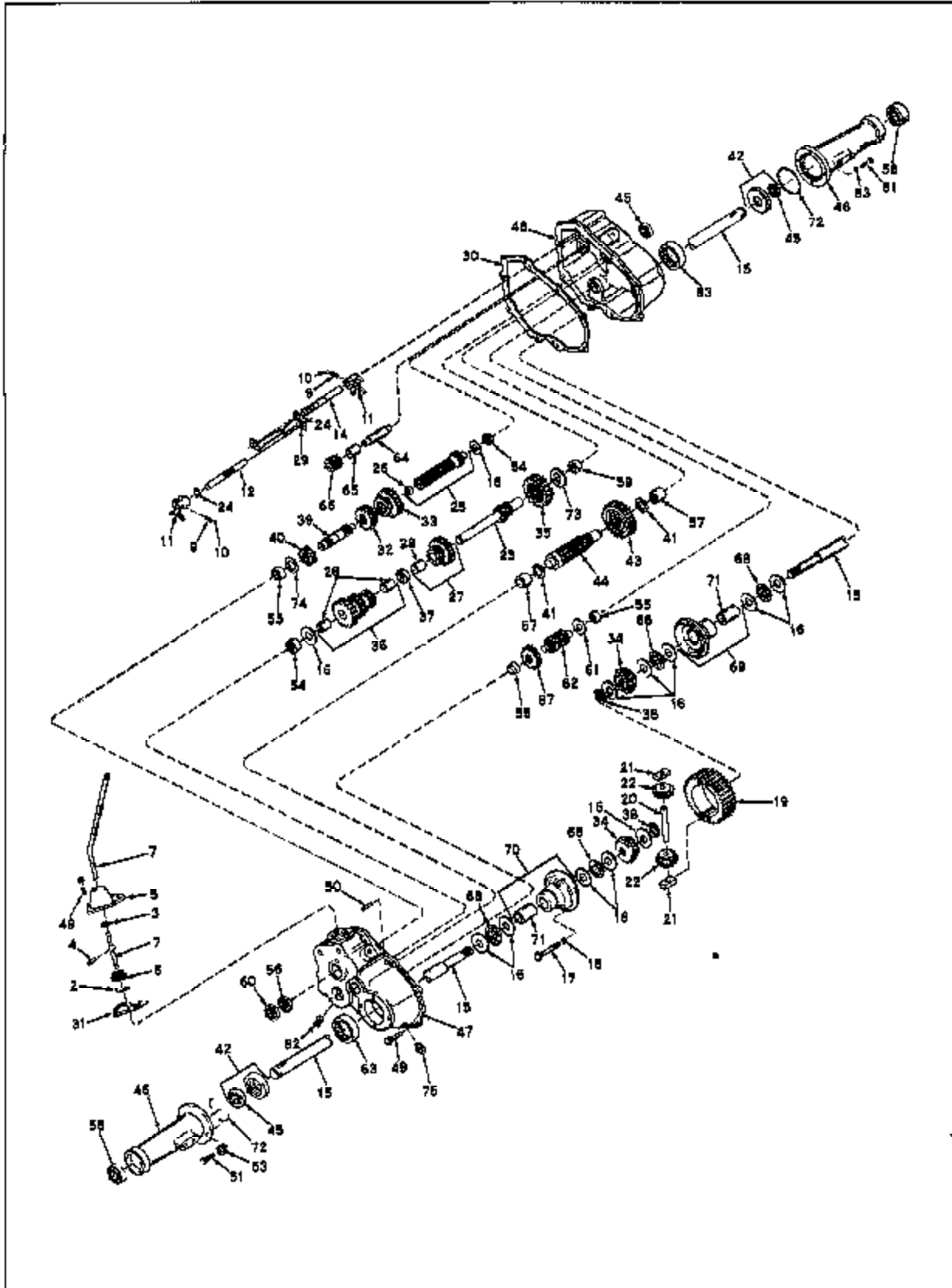
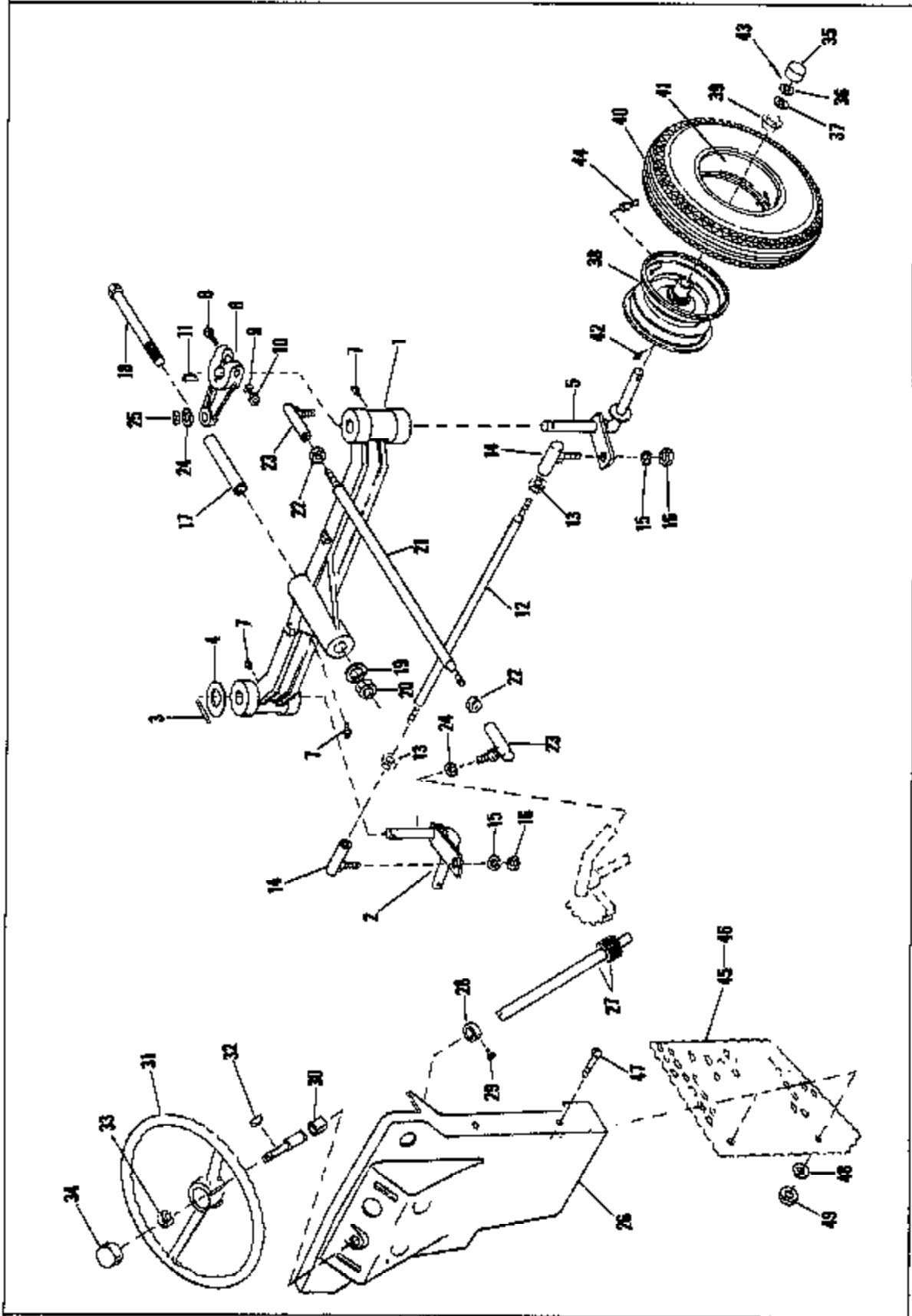

ILLUSTRATION 2.

PARTS LIST - 8 H.P. TRACTOR
TRANSMISSION ASSEMBLY
ILLUSTRATION 2.

Ref. No.	Part No.	Quan.	Description
2	590040	1	Ring - Snap
3	545313	1	Ring - Quad
4	590041	1	Pin - Roll
5	535004	1	Housing - Shift Lever
6	545314	1	Keeper - Shift Lever
7	381834	1	Lever - Shift
8	545316	2	Spring
10	590042	2	Ball - Steel
11	545318	2	Fork - Shifter
12	545317	1	Rod - Shifter
14	545318	1	Rod - Shifter
15	545319	2	Axle
16	545320	12	Washer - Thrust
17	400124	4	Screw - Hex Hd, Cap - 1/4-20 x 2-1/2
18	446128	4	Lockwasher - 1/4
19	545321	1	Gear - Ring
20	545322	1	Pin - Drive
21	545323	2	Block - Drive
22	545324	2	Pinion - Bevel
23	500382	1	Shaft and Gear - Brake
24	590043	2	Ring - Snap
25	500383	25	Shaft and Bearing Assembly - Pinion (Incl. No. 26)
26	545325	1	Bearing
27	500384	1	Gear Cluster Assembly (Incl. No. 28)
28	545326	2	Bushing
29	545327	1	Stop - Shifter
30	545328	1	Gasket - Case and Cover
31	545329	1	Gasket - Shift Lever Housing
32	545330	1	Gear - Shifting (3rd and 4th)
33	545331	1	Gear - Shifting (1st, 2nd and Reverse)
34	545332	2	Gear - Bevel
35	545333	1	Gear - Idler
36	500385	1	Gear Cluster Assembly (Incl. No. 28)
37	545334	1	Spacer
38	590044	2	Ring - Snap
39	500389	1	Shaft - Input with Gear - Reversing (Illus. 1 - Ref. 9)
40	545335	1	Spur Gear - Input Shaft
41	545336	2	Washer - Thrust
42	500386	2	Seal and Retainer Assembly - Oil (Incl. No. 45)
43	545337	1	Gear - Output
44	545338	1	Pinion - Output
45	545339	3	Seal - Oil
46	595005	2	Housing - Axle
47	500387	1	Case Assembly - Transaxle (Incl. Nos. 54, 55, 57, and 63)
48	500388	1	Cover Assembly - Transaxle (Incl. No. 54, 55, 57, 59, and 63)
49	590045	11	Screw - Socket Hd, Cap 1/4-20 x 3/4
50	590046	2	Pin - Dowel
51	400188	9	Screw - Hex Hd, Cap - 5/16-18 x 7/8
52	590047	1	Plug - Magnetic Drain
53	446134	3	Lockwasher - Split - 5/16"
54	545340	2	Bearing - Needle
55	545341	3	Bearing - Needle
56	545342	1	Bearing - Ball
57	545343	2	Bearing - Needle
58	545344	2	Bearing - Ball
59	545345	1	Bearing - Needle
60	545346	1	Seal - Oil
61	545347	1	Washer
62	545348	1	Shaft and Pinion
63	545349	2	Bearing - Needle
64	545350	1	Shaft - Reverse Idler
65	545351	1	Spacer - Reverse Idler
66	545352	1	Idler - Reverse
67	545353	1	Spur - Gear (22 Teeth)
68	545354	4	Bearing - Thrust
69	500389	1	Carrier Assembly - Differential (Incl. No. 71)
70	500390	1	Carrier Assembly - Differential (Incl. No. 71)
71	545355	2	Bushing
72	590048	2	"O" Ring
73	545356	1	Washer - Thrust
74	545357	1	Washer - Thrust
75	590049	1	Plug - Pipe

ILLUSTRATION 3.



PARTS LIST - 8 H.P. TRACTOR
ILLUSTRATION 3.

Ref. No.	Part No.	Quan.	Description	Ref. No.	Part No.	Quan.	Description
1	305218	1	Axle - Front	30	315313	1	Pushing - Steering Rod
2	128187	1	L. H. Spindle Assembly	31	128178	1	(Steering Wheel)
3	461201	1	Pin - 1/4 x 1-1/2 Type 1 Groove - Front Wheel	32	453008	1	Key - 1/8 x 1/2 Woodruff #3 - Steering Wheel Mtg.
			Spindle Washer Mtg.	33	455112	1	Nut - 5/8-11 Pin Type R. Hex - Steering Wheel Mtg.
4	452018	1	Washer - 2" O.D. for 3/4 Bolt - Front Wheel	34	545268	1	Cap - Steering Wheel
			Spindle Mtg.	35	316802	2	Cap - Front Wheel
5	125166	1	R. H. Spindle Assembly	36	312309	2	Washer - Front Wheel Retaining
6	263009	1	Steering Arm	37	304016	2	Washer - Front Wheel Retaining
7	471226	3	Fitting - 1/4 Grease S/W #1743B - R. H. and L. H.	38	113315	2	Front Wheel Disc Assembly w/328106 and 471214 (Standard)
			Spindle and Axle Grease				
8	402270	1	Screw - 3/8-16 x 2 Hex Hd. Cap - Spindle Steering Arm Mtg.	38	136035	2	Front Wheel Disc Assy w/328106 and 471214 (Wide Base)
9	445140	1	Lockwasher - 3/8 Med. - Spindle Steering Arm Mtg.	39	323106	4	Front Axle Wheel Ball Bearing
10	445110	1	Nut - 3/8-16 Hex - Spindle Steering Arm Mtg.	40		2	Front Wheel Tire - 4.00/4.80 x 8
11	465917	1	Key - Woodruff #9 - Spindle Steering Arm Mtg.	40		2	Front Wheel Tire - Wide Base - Tubelens
12	342590	1	Rod - Tie	41		2	Inner Tube - 4.00/4.80 x 8
13	443812	2	Nut - 3/8-24 Hex Jam - Ball Joints to Tie Rod Mtg.	42	471214	2	Grease Fitting - 1/4-28 - Front Wheel Disc (Standard)
14	310089	2	Ball Joint	42	471214	2	Grease Fitting - 1/4-28 - Front Wheel Disc - Wide Base
15	445140	2	Lockwasher - 3/8 Med. - Tie Rod to R. and L. H.	43	450040	2	Cotter Pin - 5/32 x 1-1/4 - Front Wheel (Standard) to Axle Mtg.
16	443112	2	The Rod Brkt. Mtg.	43	450040	2	Cotter Pin - 5/32 x 1-1/4 - Front Wheel (Wide Base)
17	315386	1	Tube - Front Axle Support	44	541679	2	Tire Valve - Wide Base - Tubelens
18	400560	1	Screw - 5/8-18 x 5 Hex Hd. Cap - Front Axle to Frame	45	342934	1	Screen - Side - R. H.
			Frame	46	342933	1	Screen - Side - L. H.
19	446152	1	Lockwasher - 5/8 L. - Front Axle to Frame	47	404018	4	Screw - 1/4-20 x 3/4 Slotted Truss Hd. Mach.
20	443828	1	Nut - 5/8-18 Hex - Front Axle to Frame	48	452006	4	Washer - 1/4 STD
21	342590	1	Link - Drag	49	443102	4	Nut - 1/4-20 Hex
22	443812	2	Nut - 3/8-24 Hex Jam - Ball Joint to Drag Link				
23	310089	2	Ball Joint				
24	446140	2	Lockwasher - 3/8 Med. - Drag Link to Steering Arm Mtg. and Steering Quadrant				
25	443112	1	Nut - 3/8-24 Hex - Drag Link to Steering Arm Mtg.				
26	306320	1	Rear Panel				
27	152457	1	Steering Rod and Pinion Assembly				
28	341825	1	Collar - Steering Rod				
29	412013	1	Screw - 5/16-18 x 1/2 Sq. Hd. Cup Pt. Set - Steering Rod Collar Mtg.				

ILLUSTRATION 4.

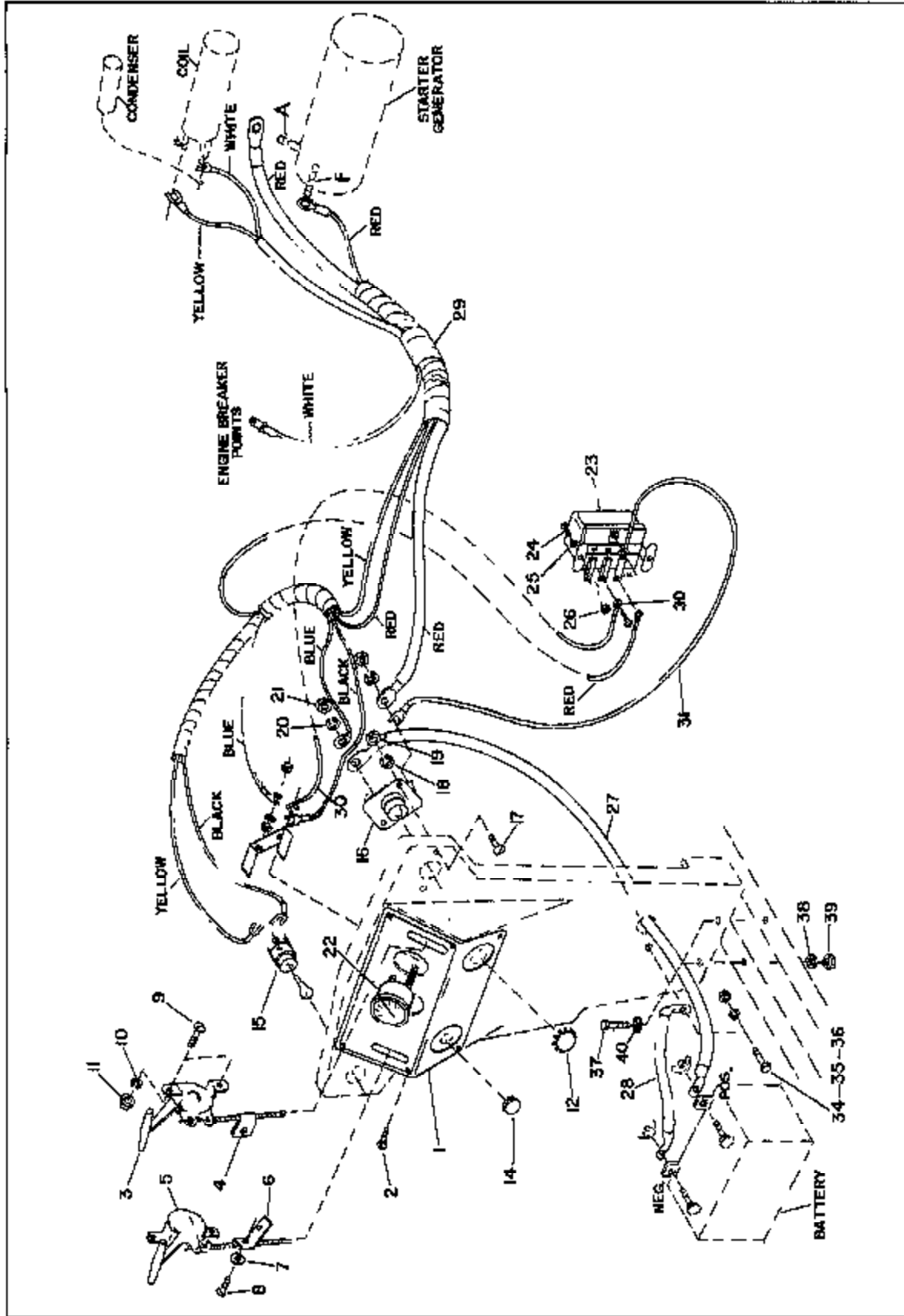

PARTS LIST - 8 H. P. TRACTOR
ILLUSTRATION 4.

Ref. No.	Part No.	Quan.	Description	Ref. No.	Part No.	Quan.	Description
1	328948	1	Plate - Dash Panel	22	107917	1	Ammeter
2	402613	6	Screw - #7 x 5/16 Rd. Hd. Drive - Dash Panel Mtg.	23	107927	1	Regulator - Voltage
3	153537	1	Throttle Control Assembly w/Clip - 303451	24	404024	2	Screw - 1/4-20 x 1-1/4 Slotted Truss Hd. Machine - Voltage Regulator Mtg.
4	803451	1	Clip - Throttle Control Mtg.	25	446128	2	Lockwasher - 1/4 - Med. - Voltage Regulator Mtg.
5	153536	1	Choke Control Assembly w/Bracket - 325819	26	443102	2	Nut - 1/4-20 - Hex - Voltage Regulator Mtg.
6	325819	1	Bracket - Choke Control Mtg.	27	342685	1	Cable - Battery to Starter Button
7	455008	1	Washer - 3/16 - Bracket to Choke Control Assembly Mtg.	28	342684	1	Cable - Battery to Ground
8	408656	1	Screw - #8-32 x 1/2 Truss Hd. Machine - Bracket to Choke Control Assembly Mtg.	29	119118	1	Wiring Harness Assembly
9	408314	4	Screw - #10-24 x 3/4 Truss Hd. Machine - Choke and Throttle Control to Panel	30	342682	1	Cable - Ammeter to Regulator
10	446116	4	Lockwasher - #10 - Med. - Choke and Throttle Control to Panel	31	342683	1	Cable - Regulator to Starter
11	444310	4	Nut - #10-24 - Hex - Choke and Throttle Control to Panel	34	400188	1	Screw - 5/16-18 x 1 - Hex Hd. Cap - Ground Cable to Panel Mtg.
12	341828	1	Plug - Button - Lighter Hole	35	446124	1	Lockwasher - 5/16 - Med. - Ground Cable to Panel Mtg.
14	325908	1	Plug - Button - Light Switch Hole	36	443106	1	Nut - 5/16 -18 - Hex - Ground Cable to Panel Mtg.
15	153722	1	Ignition Switch Assembly	37	400264	2	Screw - 3/8-16 x 1-1/4 Hex Hd. Cap - Rear Panel to Frame
16	342553	1	Starter Button	38	446140	2	Lockwasher - 3/8 - Med. - Rear Panel to Frame
17	404016	2	Screw - 1/4-20 x 3/4 Slotted Truss Hd. Machine - Starter Button Mtg.	39	443110	2	Nut - 3/8-16 - Hex - Rear Panel to Frame
18	446126	2	Lockwasher - 1/4 - Med.	40	303873	2	Washer - Rear Panel to Frame
19	443102	2	Nut - 1/4-20 - Hex - Starter Button Mtg.				
20	446140	2	Lockwasher - 3/8 - Med. - Starter Cable to Starter Button Mtg.				
21	443810	2	Nut - 3/8-16 Hex Jam - Starter Cable to Starter Button Mtg.				

ILLUSTRATION 5.

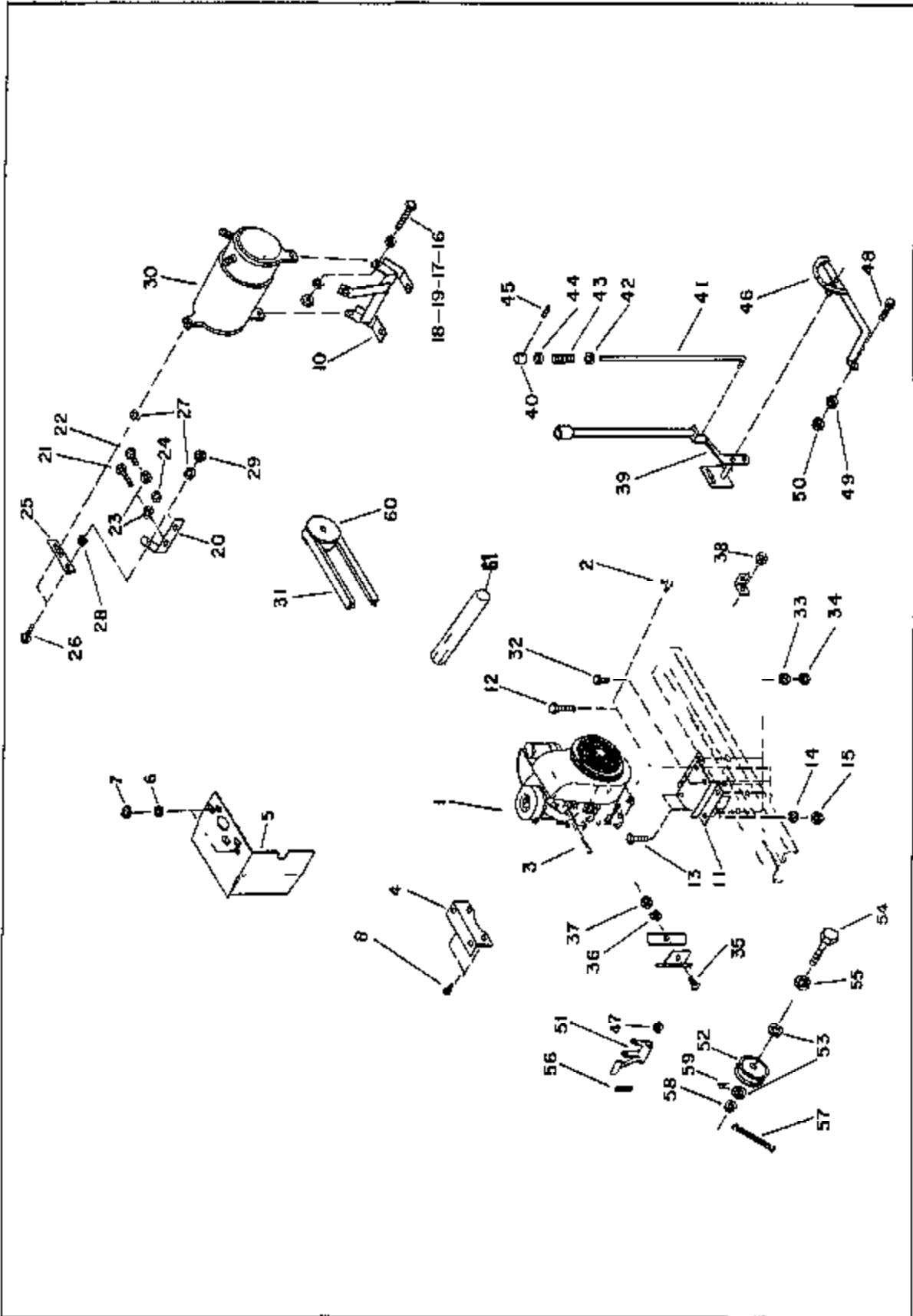

PARTS LIST - B H.P. TRACTOR
ILLUSTRATION 5.

Ref. No.	Part No.	Quan.	Description	Ref. No.	Part No.	Quan.	Description
1		1	Engine Kohler - K-181 Spec. No. 30280D	20		1	Starter - Generator Assembly
2	314044	1	Firing - Fuel Line on Carburetor	31	315402	1	Belt - Start - Gen. Drive
3	403532	1	Screw - #8-32 x 7/8 Rd. Hd. Machine - Air Horn Mfg.	32	342861	4	Bolt - Engine Bracket to Frame Mfg.
4	128072	1	Upper Bracket Assembly - Front Guard	33	448140	4	Lockwasher - 3/8 - Med. - Engine Bracket to Frame Mfg.
5	331585	1	Deflector - Heat	34	448110	4	Nut - 3/8-16 - Hex - Engine Bracket to Frame Mfg.
6	452006	2	Washer - 5/16 - SAE - Deflector Mfg.	35	403986	1	Screw - #10-32 x 1/2 Truss Rd. Machine - Throttle Control to Engine Mfg.
7	443106	2	Nut - 5/16-18 - Hex - Deflector Mfg.	36		1	Lockwasher - #10 - Med. - Throttle Control to Engine Mfg.
8	400256	2	Screw - 3/8-16 x 3/8 Hex Hd. Cap - Upper Guard Bracket Mfg.	38	448116	1	Nut - #10-32 - Hex - Throttle Control to Engine Mfg.
10	107946	1	Start - Gen. Bracket Assembly - Lower	37	444312	1	Engine Mfg.
11	331582	1	Bracket - Engine Mfg.	38	448110	1	Lockwasher - #8 - Med. - Choise Control Clip to Air Horn Mfg.
12	400264	2	Screw - 3/8-16 x 1-1/4 Hex Hd. Cap - Bracket to Engine Mfg. - Front	39	128177	1	Tool Lift Lever Assembly
13	400266	2	Screw - 3/8-16 x 1-1/8 Hex Hd. Cap - Bracket to Engine Mfg. - Rear	40	315349	1	Plunger - Lift Lever
14	448140	4	Lockwasher - 3/8 - Med. - Bracket to Engine Mfg.	41	315243	1	Rod - Lift Lever Plunger
15	443110	4	Nut - 3/8-18 - Hex - Bracket to Engine Mfg.	42	310590	1	Collar
16	400180	2	Screw - 5/16-18 x 1-1/4 Hex Hd. Cap - Start - Gen to Lower Bracket Mfg.	43	315344	1	Spring - Lift Lever Plunger
17	446134	2	Lockwasher - 5/16 - Med. - Start - Gen. to Lower Bracket Mfg.	44	343332	1	Washer - Lift Lever Handle Spacer
18	443106	2	Nut - 5/16-18 - Hex - Start - Gen. to Lower Bracket Mfg.	45	451355	1	Pin - 1/8 x 1/2 - Roll - Lift Lever Handle Spacer Mfg.
19	308949	AR	Washer - Start - Gen. to Bracket Mfg.	46	112517	1	Lift Sector Assembly
20	107942	1	Start - Gen. - Upper Mfg. Bracket Assembly	47	311039	1	Spacer - Lift Lever Mfg.
21	400253	1	Screw - 3/8-16 x 3/4 Hex Hd. Cap - R.H. Upper Bracket Mfg.	48	400189	1	Screw - 5/16-18 x 1 Hex Hd. Cap - Sector to Frame Mfg.
22	400262	1	Screw - 3/8-16 x 1 Hex Hd. Cap - L.H. Upper Bracket Mfg.	49	448124	1	Lockwasher - 5/16 - Med. - Sector to Frame Mfg.
23	448140	2	Lockwasher - 3/8 - Med. - R.H. and L.H. Upper Bracket Mfg.	50	448106	1	Nut - 5/16-18 - Hex - Sector to Frame Mfg.
24	452008	1	Washer - 1" O.D. - R.H. Upper Bracket Mfg.	51	238021	1	Pedal - Brake and Clutch
25	315420	1	Link - Start - Gen. Mfg.	52	108151	1	Clutch and Idler Pulley
26	440184	2	Screw - 5/16-18 x 3/4 Hex Hd. Cap - Upper Start - Gen. and Link Mfg.	53	342863	2	Spacer - Idler Pulley
27	448134	2	Lockwasher - 5/16 - Med. - Upper Start - Gen. and Link Mfg.	54	400640	2	Screw - 5/8-18 x 1-1/4 Hex Hd. Cap - Clutch and Idler Pulley Mfg.
28	452006	1	Washer - 7/8 - O.D. - Upper Start - Gen. and Link Mfg.	55	448164	1	Lockwasher - 5/8 - Med. - Clutch and Idler Pulley Mfg.
29	443106	1	Nut - 5/16-18 - Hex - Upper Start - Gen. and Link Mfg.	56	461377	1	Pin - 5/32 x 1-1/8 - Roll - Clutch and Brake Pedal Mfg.
				57	342862	1	Spring - Bell Tension
				58	463009	1	Washer - 5/16 - SAE - Brake Rod Spring Mfg.
				59	460014	1	Pin - 3/32 x 3/4 - Cotter - Brake Rod Spring Mfg.
				60	315404	1	Pulley - Starter - Generator
				61	342813	1	Hex Wrench - Engine Oil Drain Plug

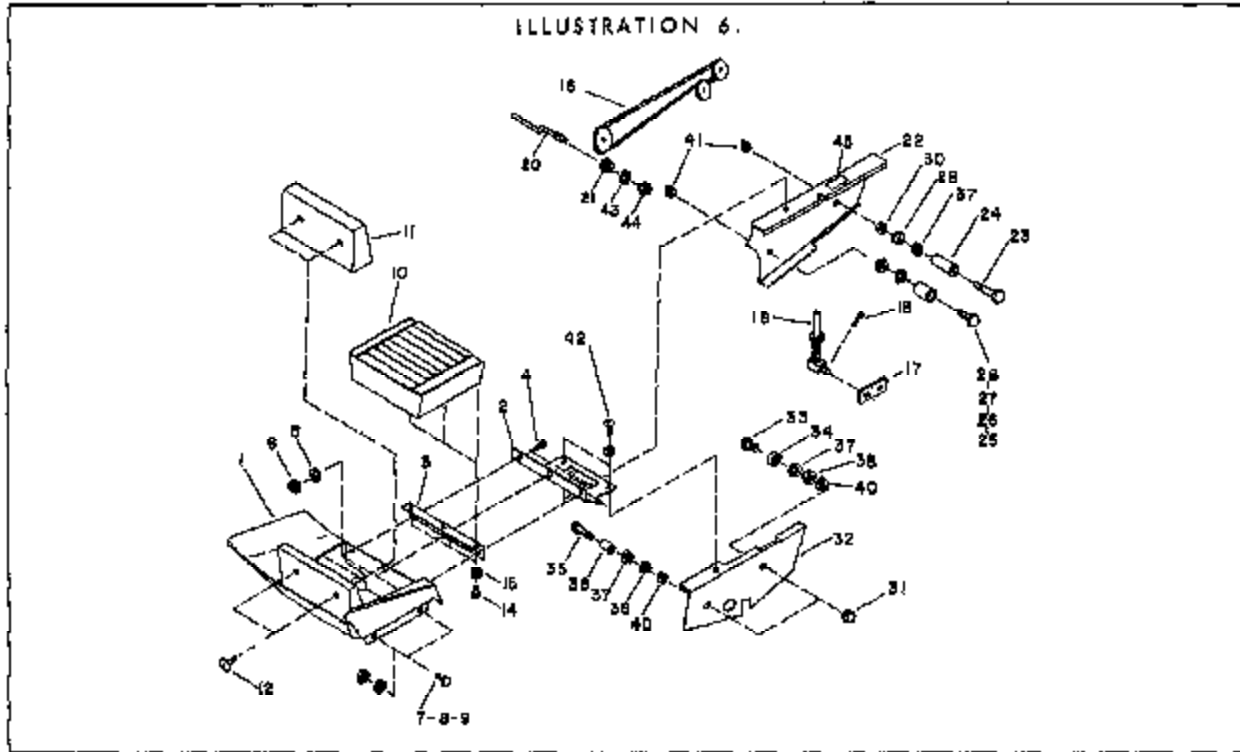

PARTS LIST - 8 H.P. TRACTOR
ILLUSTRATION 6.

Ref. No.	Part No.	Quan.	Description	Ref. No.	Part No.	Quan.	Description
1	119114	1	Fender and Seat Assem.	25	400198	1	Screw - 5/16-18 x 2-1/4 Hex Hd. Cap - Rear Belt Guard Mtg.
2	331531	1	Apron - Seat Front	26	342648	1	Spacer - Rear Belt Guard Mtg.
3	342662	1	Hinge - Seat	27	448134	3	Lockwasher - 5/16 Med - Belt Guard Mtg.
4	404014	3	Screw - 1/4-20 x 1/2 Slotted Truss Hd Mach.	28	443806	2	Nut - 5/16-18 Hex Jam - Spacers to Tractor Retainer
6	448128	3	Lockwasher - 1/4 Med. Seat Hinge and Apron Fender Mtg.	29	443108	1	Nut - 5/16 -18 Hex - Belt Guard Mtg.
6	443102	3	Nut - 1/4-20 Hex Seat Hinge and Apron Fender Mtg.	30	463009	2	Washer - 5/16 SAE Std. - Belt Guard Mtg.
7	400184	3	Screw - 5/16-18 x 3/4 Hex Hd. Cap Seat to Frame	31	445010	3	Nut - 5/16-18 Hex Acorn - Belt Guard Mtg.
8	448134	3	Lockwasher - 5/16 Med. - Seat to Frame	32	126190	1	R. H. Guard Assembly
9	443106	3	Nut - 5/16-18 Hex - Seat to Frame	33	400190	1	Screw - 5/16-18 x 1-1/4 Hex Hd. Cap - Front R. H. Guard Mtg.
10	328349	1	Cushion - Seat	34	925522	1	Spacer - Front R. H. Guard - 3/8 thick
11	331533	1	Cushion - Back	35	400198	1	Screw - 5/16-18 x 2-1/4 Hex Hd. Cap - Rear R. H. Guard Mtg.
12	404018	2	Screw - 1/4-20 x 3/4 Truss Hd. Mach. - Back Cushion Mtg.	36	342648	1	Spacer - Rear R. H. Guard 1-1/2 lg
14	404016	3	Screw - 1/4-20 x 3/4 Truss Hd Mach - Seat to Hinge	37	448134	3	Lockwasher - 5/16 Med. - R. H. Guard Mtg
15	453023	3	Washer - 1/4 SAE - Seat to Hinge	38	443806	2	Nut - 5/16-18 Hex Jam - Spacers to Tractor Mtg.
16	342660	1	Belt - Transmission	39	443106	1	Nut - 5/16-18 Hex - R. H. Guard Mtg.
17	342658	1	Arm - Parking Brake Lock	40	463009	2	Washer - 5/16 SAE STD - Belt Guard Mtg
18	460038	1	Pin - 5/32 x 1 Cotter - Arm to Park Brakes Lock Mtg.	41	445010	2	Nut - 5/16-18 Hex Acorn - Belt Guard Mtg.
19	153686	1	Parking Brake Assembly	42	404014	2	Screw - 1/4-20 x 1/2 - Slotted Truss Head Apron to R.H. and L.H. Guard Mtg
20	313233	1	Stud - Belt Retainer	43	448134	1	Lockwasher - 5/16 - Med.
21	443806	1	Nut - 5/16 -18 - Hex Jam	44	443106	1	Nut - 5/16-18 - Hex
22	126228	1	Belt Guard - L.H.	45	342690	1	Decal - Brake Lock
23	401018	1	Screw - 5/16-18 x 3-1/4 - Hex Hd. Cap Front Belt Guard Mtg				
24	328489	1	Spacer - Belt Guard and Parking Brake				

ILLUSTRATION 7.

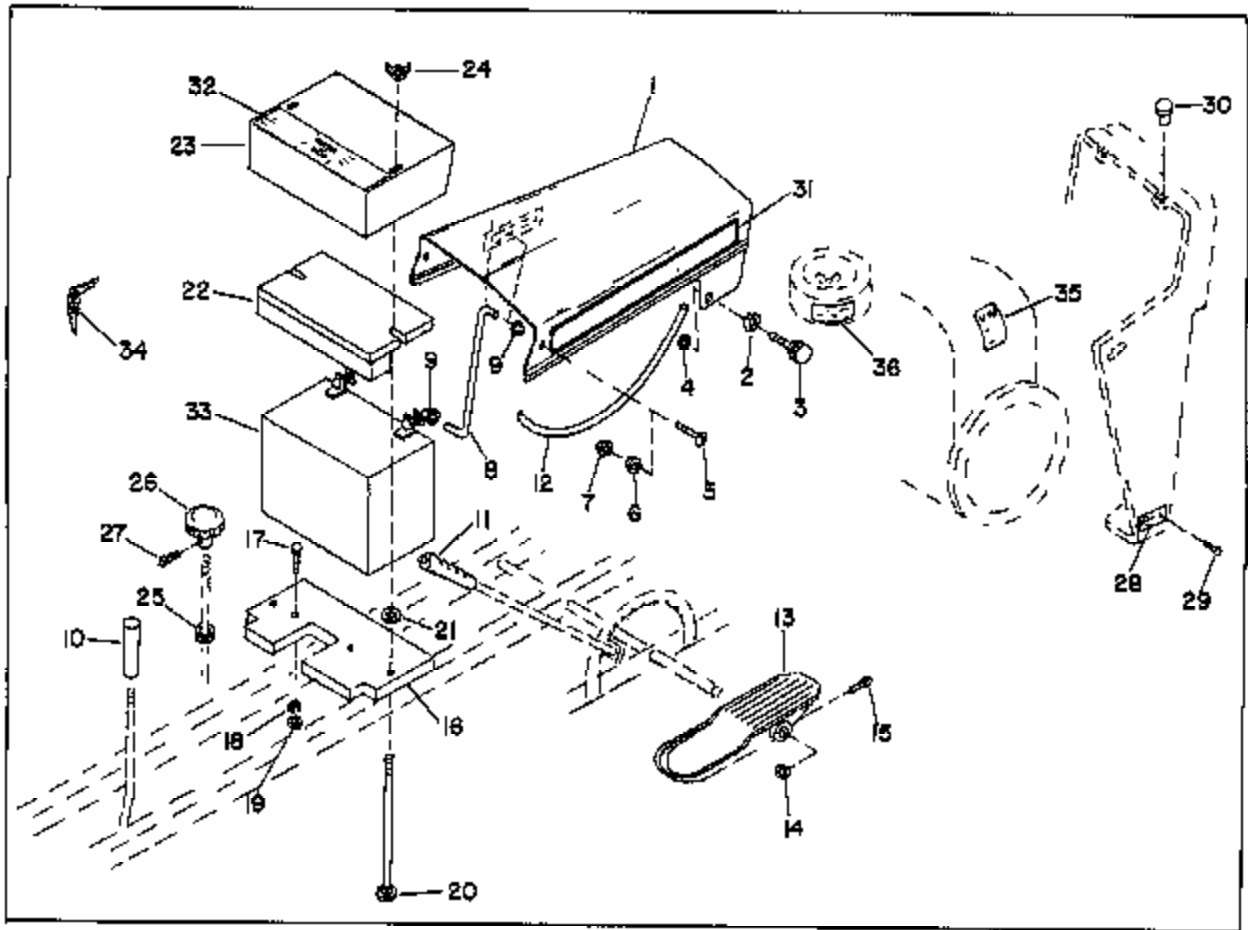

PARTS LIST - 8 H.P. TRACTOR
ILLUSTRATION 7.

Ref. No.	Part No.	Quan.	Description	Ref. No.	Part No.	Quan.	Description
1	120181	1	Hood Assembly	18	446128	2	Lockwasher - 1/4 Msd. Carrier Block to Frame Mtg.
2	447010	2	Lockwasher - 1/4 Ext. Tooth	19	443102	2	Nut - 1/4-20 Hex Carrier Block to Frame Mtg
3	342858	2	Screw - Hood Latch	20	342590	2	Bolt - Battery Hold Down
4	458054	2	Retaining Ring - Hood Fastener	21	458054	2	Ring Truero - Battery Hold Down Bolt Retaining
5	400190	2	Screw - 5/16-18 x 1-1/4 Hex Hd Cap	22	331549	1	Block - Battery Hold Down
6	443808	2	Nut - 5/16-18 Hex Jam	23	331543	1	Cover - Battery
7	445010	2	Nut - 5/16-18 Hex Acorn	24	445012	2	Nut - 1/4-20 Std. Wing Battery Cover Mtg.
8	342013	1	Rod - Hood Support	25	308400	1	Grommet - Parking Brake
9	445252	2	Nut - 1/4 Push on cap Type B Tinnerman Hood Support Rod to Panel and Hood Mtg.	26	342656	1	Handle - Parking Brake
10	342582	1	Knob - Shift Lever	27	412001	1	Screw - #10-32 x 1/2 Sq. Hd. Cup Pt. Set Handle to Borsw Retaining
11	341833	1	Grup - Lift Lever	28		1	Serial No. Plate
12	342427	1	Fuel Line	29	408508	2	Screw - #2 x 1/4 Rd. Hd. Self-Tap Serial Plate Mtg.
13	204158	2	Foot Rest	30	325037	2	Bumper - Rubber Hood
14	444508	2	Nut - 5/16-18 Sq. Foot Rest Mtg.	31	545284	2	Decal - Tractor Name
15	412020	2	Screw - 5/16-18 x 1 Sq. Hd. Cup Pt Set Foot Rest Mtg.	32	331501	1	Decal - Gear Shaft
16	342598	1	Block - Battery Carrier	33		1	Battery - 12volt w/Cable Mtg. Hdwy.
17	440050	2	Bolt - 1/4-20 x 1-1/2 Rd. Hd. Sh Sq. Carr Carrier Block to Frame Mtg.	34	343060	1	Key - Ignition (Set of Two)
				35	341484	1	Decal - 8 H.P. Engine
				36	341485	1	Decal - Engine Air Cleaner

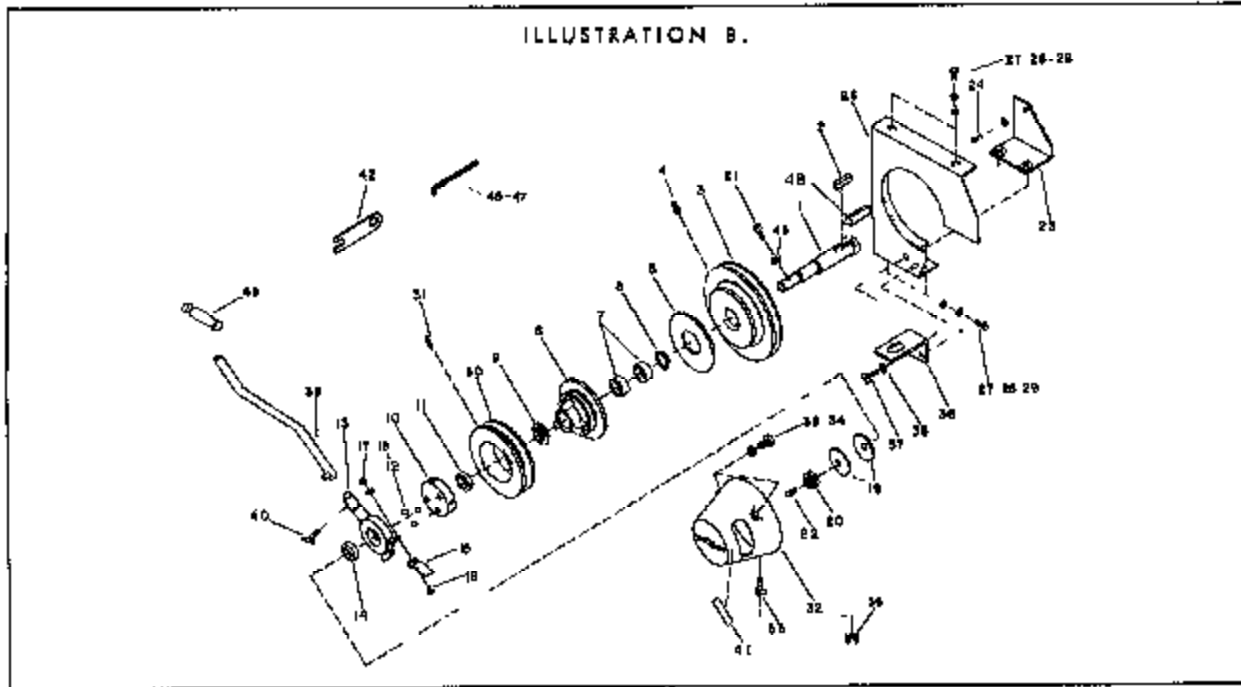

ILLUSTRATION B.
PARTS LIST
POWER DRIVE CLUTCH FOR 8 H.P., 10 H.P. AND 12 H.P.
ILLUSTRATION B.

Ref. No.	8 H.P. Part No.	10 H.P. & 12 H.P. Part No.	Quan.	Description	Ref. No.	8 H.P. Part No.	10 H.P. & 12 H.P. Part No.	Quan.	Description
1	331545*	331547*	1	Extension Shaft	28	128182	128182	1	Front Guard Assembly
2	342806*	342607*	2	Key-Extension & Engine Pulley Mtg.	27	400182		4	Screw - 5/16-18 x 5/8 Hex Hd. Cap - Front Guard Mtg.
3	289021*	289022*	1	Pulley - Engine	27		400182	8	Screw - 5/16-18 x 5/8 Hex Hd. Cap - Front Guard Mtg.
4	415527	415527	2	Screw - 5/16-18 x 3/4 Soc. Hd. Kn. Cup Pt. Set Engine & Pulley Mtg.	28	452004		4	Washer - 5/16 - St'd. - Front Guard Mtg.
5	331546	331546	1	Disc - Friction Clutch	28		462006	3	Washer - 5/16 - St'd. - Front Guard Mtg.
6	163489*	163494*	1	P.T.O. Pulley Assembly	29	448134		4	Lockwasher - 5/16 - Med. - Front Guard Mtg.
7	342812	342812	2	Bearing - Needle	29		448134	8	Lockwasher - 5/16 - Med. - Front Guard Mtg.
8	342598	342598	1	Seal - Oil	30	239019	239019	1	Pulley - Rotary - P.T.O.
9	342597	342597	1	Washer	31	415559	415559	8	Screw - 5/16-18 x 1 Soc. Hd. Cup Pt. Set
10	153493	153493	1	Cam Backing Plate Assembly	32	218015*	218015*	1	Cover - Clutch
11	310646	310646	1	Bearing - Ball	32	342599	342599	3	Screw - Cover Mtg.
12	466099	466099	3	Ball - 3/8 Dia. Steel (Cam Clutch)	34	342594	342594	2	Washer - Cover Mtg.
13	153834	153834	1	Cam Plate Assembly	35	342849	342849	1	Cap - Anti-Rattle
14	310848	310848	1	Bearing - Ball	36	342609*	342602*	4	Stop - Cam Backing Plate
15	342742	342742	2	Spring - Cam Engaging	37	342800	342800	1	Screw - Stop Mtg. Wing
16	402058	402058	2	Screw - #8-32 x 3/8 Truss Hd. Cam Spring to Cam Stop Mtg.	38	445218	445218	1	Nut - 1/4 Push-On Timmerman
17	448110	448110	2	Lockwasher - #8 - Med. Cam Spring to Cam Stop Mtg.	39	153661	153661	1	Clutch Lever Assembly - (In Tool Box)
18	444306	444306	2	Nut - #8-32 - Hex - Cam Spring to Cam Stop Mtg.	40	153879	153879	1	T-Screw - Clutch Lever Mtg.
19	342610	342610	2	Washer - Spring	41	342882	342882	1	Decal - Clutch
20	342891	342891	1	Nut - Clutch Lock	42	342850	342850	1	Gauge - Clutch Adjusting (In Tool Box)
21	484023	484023	1	Screw - 1/4-20 x 1-1/4 - Soc. Hd. Cap - Clutch Lock Nut	43	326173	326173	1	Grip - Lever
22	471228	471228	1	Fitting - Grease 1/4-28 NF Alumite #1698 Ext. Shaft	45	448128	448128	1	Lockwasher - 1/4 - Med. Clutch Lock Nut
23	153498*	153498*	1	Lower Bracket Assembly - Front Guard	46	471001	471001	1	Wrench - 5/16 - Soc. Hd. Cap Screw
24	400256*	400256*	1	Screw - 7/16-14 x 5/8 Hex Hd. Cap - Lower Brkt. to Eng. Mtg.	47	471002	471002	1	Wrench - 1/4 - Soc. Hd. Cap Screw
				Screw - 3/8-18 x 5/8 Hex Hd. Cap - Lower Bracket to Engine Mounting	48	343304	343304	1	Seal - Grease

PARTS LIST
10 H.P. AND 12 H.P. TRACTORS

NOTE: The 10 H.P., 12 H.P. and 8 H.P. Tractors are similar except for the following differences. The following parts from the 8 H.P. Tractor are not used on the 10 H.P. and 12 H.P. Tractors.

Part No.	Illus. No.	Ref. No.	Part No.	Illus. No.	Ref. No.	Part No.	Illus. No.	Ref. No.
114026	1	1	443106	6	7	400266	6	8
205219	1	62	Koh. 8 H.P.	6	1			8
153537	4	3	403322	6	3	107848	6	10
153536	4	5	125072	5	4	400180	5	16
325818	4	8	400268	5	21	448134	5	17
455008	4	7	400262	5	22	448108	5	18
403658	4	8	446140	5	23	308848	5	19
119118	4	29	452068	5	24	107842	5	20
331592	5	11	315420	5	25	448116	5	26
400264	5	12	400184	5	26	444812	5	27
400266	5	13	448134	5	27	448110	5	28
448140	5	14	443106	5	28	342427	7	12
448110	5	15	8 H.P. St./Gen.	5	30	545264	7	31
342861	6	32	315404	5	30	341484	7	36
			315402	5	31			
452006	5	9	403936	6	35			

NOTE: The following parts for the 10 H.P. Tractor are not illustrated. These parts are very similar to the parts illustrated in the 8 H.P. Tractor.

PARTS LIST

12 H.P. & 10 H.P. Part No.	Quan	Description	8 H.P. Part No	Illus No	Ref No.
Kohler 12 H.P.	1	Engine Assembly - K-301 - Spec 4765-B	Kohler 8 H.P.	5	1
Kohler 10 H.P.	1	Engine Assembly - K-241-S Spec No 48264D	Kohler 8 H.P.	5	1
114033	1	Frame Assembly	114026	1	1
206221	1	Front Cowling	205219	2	62
153547	1	Throttle Control Lever Assembly with Clip 303451	153537	4	3
153549	1	Choke Control Lever Assembly with Clip 303451	153536	4	5
303451	2	Clip - Choke and Throttle Control Mounting	303451	4	4
327713	1	Support - Choke Wire Housing Mounting on Engine	325819	4	6
446128	1	Lockwasher - 1/4 Med - Choke Clip to Support Mounting			
404014	1	Screw - 1/4-20 x 1/2 - Choke Clip to Support Mounting			
204266	1	Manifold - Exhaust			
342428	1	Line - Fuel	342427	7	12
341483	1	Decal - 10 H.P. Engine	341484	7	35
343262	1	Decal - 12 H.P. Engine	341484	7	35
315362	4	Bolt - Eng. Mounting - 10 H.P., 12 H.P.	342861	5	32

ILLUSTRATION 9.

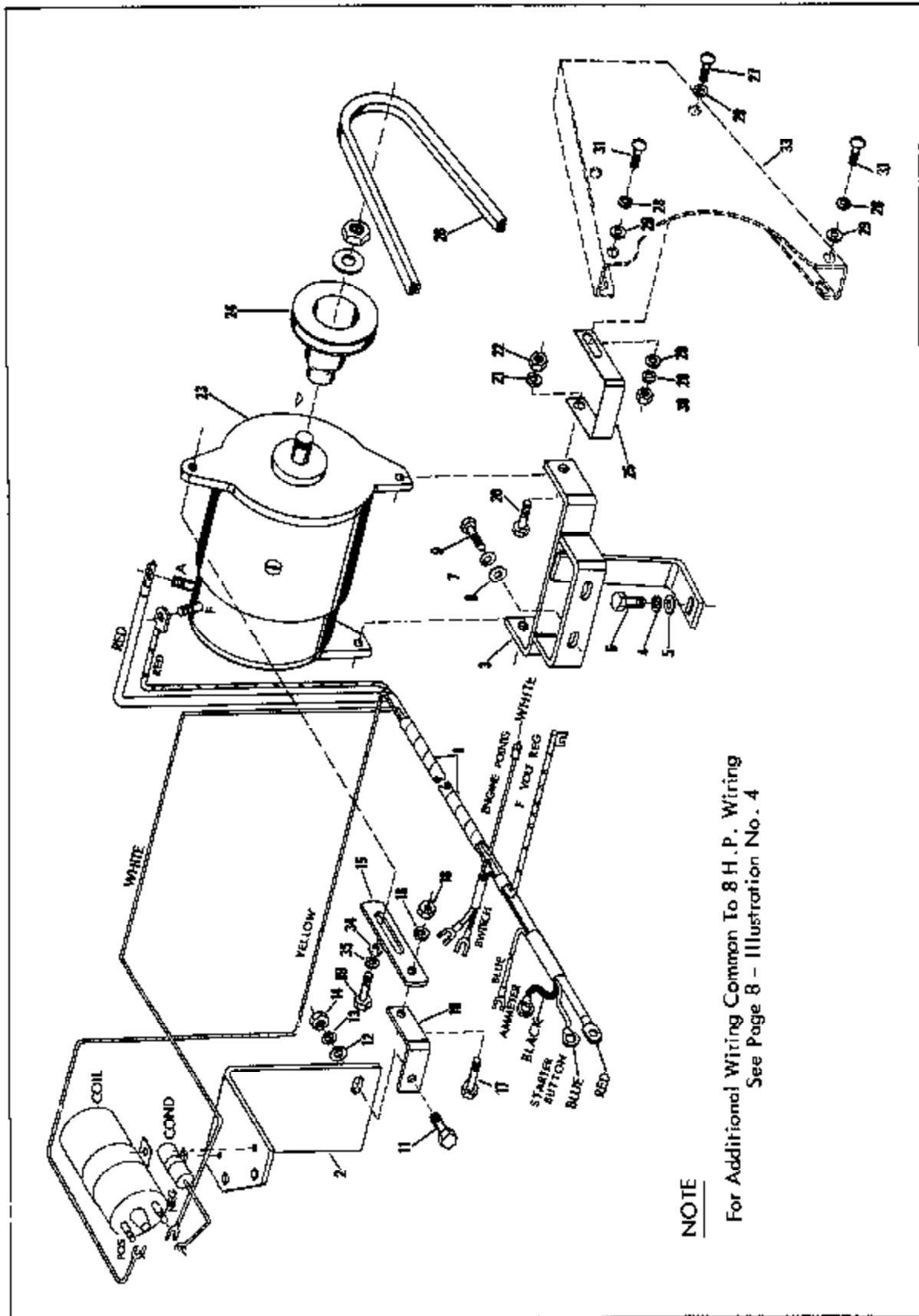

NOTE

For Additional Wiring Common To 8 H.P. Wiring
See Page 8 - Illustration No. 4

PARTS LIST - 10 H.P. AND 12 H.P.
ELECTRICAL SYSTEM
ILLUSTRATION 9.

Ref. No.	Part No.	Quan.	Description	Ref. No.	Part No.	Quan.	Description
1	119120	1	Starter Cables & Coil Harness	19	400188	1	Screw - 5/16-18 x 1 Hex Hd. Cap
2	342919	1	Bracket - Start./Gen. Adjusting Strap	20	400190	2	Screw - 5/16-18 x 1-1/4 Hex Hd. Cap
3	113023	1	Bracket Assembly - Start./Gen.	21	446134	2	Lockwasher - 5/16 Med.
4	446140	1	Washer - 3/8 SAE	22	443109	2	Nut - 5/16-18 Hex.
5	453011	1	Lockwasher - 3/8 SAE	23	113034	1	Start./Gen. Assembly
6	406266	1	Screw - 3/8-18 x 1-1/8 Hex Hd. Cap	24	204287	1	Pulley - Start./Gen.
7	446140	2	Washer - 3/8 SAE	26	326236	1	Drags - Belt Guard
8	453011	2	Lockwasher - 3/8 SAE	26	326237	1	Belt - Start./Gen.
9	400262	2	Screw - 3/8-15 x 1 Hex Hd. Cap	27	402254	1	Screw - 1/4-20 x 1/2 Rd. Hd. Mach
10	326222	1	Support - Start./Gen. Adjusting Strap	28	446128	3	Lockwasher - 1/4 Med.
11	400262	1	Screw - 3/8-15 x 1 Hex Hd. Cap	29	453023	4	Washer - 1/4 SAE
12	453011	1	Washer - 3/8 SAE	30	443102	1	Nut - 1/4-20 Hex
13	446140	1	Lockwasher - 3/8 Med.	31	402222	2	Screw - 1/4-20 x 1/2 Rd. Hd. Mach
14	443110	1	Nut - 3/8-16 Hex				
15	326228	1	Link - Start./Gen. Adjusting	33		1	Kobler Engine Belt Guard (Order from Kobler Co.)
16	446134	1	Lockwasher - 5/16 Med.	34	452006	2	Washer - 3/8 from 8 H.P. Tractor)
17	400188	1	Screw - 5/16-18 x 1 Hex Hd. Cap	35	446134	1	Lockwasher - 5/16 Med. (from 8 H.P. Tractor)
18	443106	1	Nut - 5/16-18 Hex				

ILLUSTRATION 10.

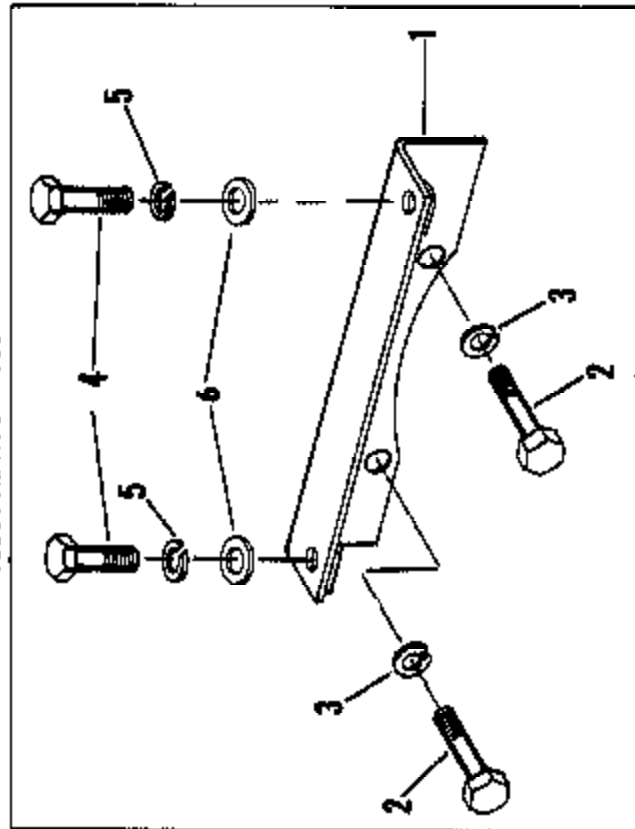

PARTS LIST - 10 H.P. AND 12 H.P.

ILLUSTRATION 10

Ref. No.	Part No.	Quan.	Description
1	152164	1	Bracket - Front Guard - Upper
2	400328	2	Screw - 7/16-14 x 5/8 Hex Hd. Cap
3	446146	2	Lockwasher - 7/16 Med.
4	400183	2	Screw - 5/16-18 x 5/8 Hex Hd. Cap
5	446134	2	Lockwasher - 5/16 Med.
6	452006	2	Washer - 3/8 SAE

NOTES

HOW TO ORDER REPAIR PARTS**IMPORTANT**

DO NOT MISLAY OR LOSE YOUR PARTS LIST AS THIS IS THE ONLY MEANS YOU HAVE OF ORDERING REPLACEMENT PARTS ACCURATELY.

To eliminate error and speed delivery:

1. Write your NAME and ADDRESS on your order PLAINLY.
2. Explain WHERE and HOW to make shipment.
3. GIVE PRODUCT NUMBER, and SERIAL NUMBER that is stamped on the NAME PLATE of your product.
4. Order from your PARTS LIST as this is the ONLY means we have of identifying the parts you need. Order by QUANTITY DESIRED, the PART NUMBER, and the DESCRIPTION OF PART.
5. Send your order to your nearest JACOBSEN DEALER, AUTHORIZED SERVICE STATION, or

AUTHORIZED JACOBSEN SERVICE DISTRIBUTOR as indicated in your SERVICE STATION DISTRIBUTOR'S DIRECTORY.

6. INSPECT ALL SHIPMENTS ON RECEIPT, if any parts are damaged or missing, file a claim with the carrier before accepting.
7. Do not return material to your nearest JACOBSEN DEALER, AUTHORIZED SERVICE STATION or AUTHORIZED JACOBSEN SERVICE DISTRIBUTOR without a letter of explanation. Make a list of all returned parts, show your name and address and include it with the shipment. TRANSPORTATION CHARGES MUST BE PREPAID.

**WARRANTY**

Jacobsen Consumer Products are guaranteed to the original retail purchaser against defective material and workmanship for ONE YEAR from date of purchase OR FOR 45 DAYS IF USED FOR COMMERCIAL OR RENTAL PURPOSES. The Jacobsen Manufacturing Company will replace defective parts free of charge f.o.b. any Jacobsen Service Station, except items warranted by the original manufacturer such as engines or other products that carry a separate warranty.

This warranty will not apply to Jacobsen products repaired or altered outside of a Jacobsen Service Station.

CUSTOMER PLEASE NOTE

Service related to normal maintenance items listed below under "Responsibility of the User" are not included under this warranty. Service required on these items will be furnished at reasonable prices.

RESPONSIBILITY OF THE USER

1. Adjustments to carburetor, ignition points or spark plug.
2. Adjustments made necessary through normal operation.
3. Sharpening of blades.
4. Failures resulting from accidental damage, misuse, improper care, negligence, or not lubricating properly.

The placing upon a Jacobsen product of any part or attachment not sold or approved by the Company shall void the warranty.

The Company reserves the right to incorporate any changes in design without obligation to make these changes on units previously sold.

JACOBSEN MANUFACTURING COMPANY

A Careful Operator

**IS THE BEST INSURANCE
AGAINST AN ACCIDENT.**

— NATIONAL SAFETY COUNCIL



JACOBSEN MANUFACTURING COMPANY
RACINE, WISCONSIN 53403

LITHO IN U.S.A.